

BPA SERIES

BPA-0400

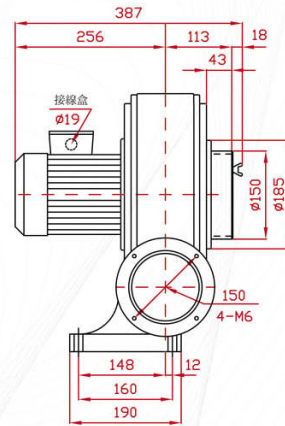

標準型 1
Standard

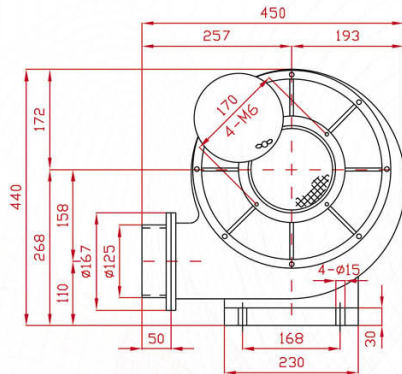
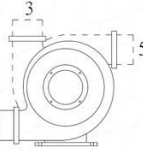

BPA-0400L

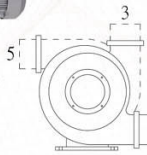

BPA-0400H

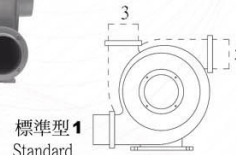

標準型 1
Standard

標準型 1
Standard

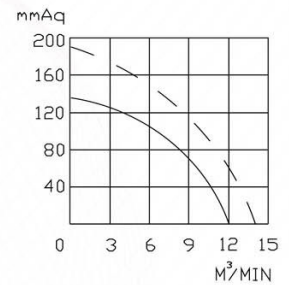
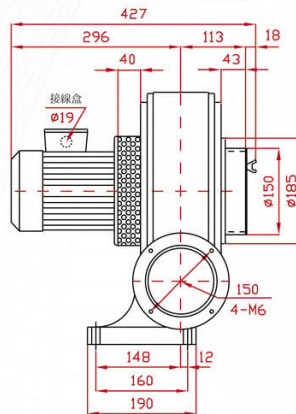
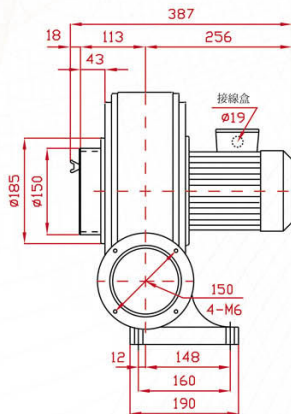

SPECIFICATIONS

型號 TYPE	功率 KW	出口口徑 MM	電壓 V	頻率 HZ	回轉數 R.P.M.	靜壓 mmAq	最大風量 M³/MIN	噪音值 dB(A)	淨重 KG(N.W.)
BPA-0400	0.4	φ 125	請指定電壓，註一 (Note 1)	50	2800	135	12	55	16
BPA-0400L				60	3300	190	14	76	
BPA-0400H									

說明 Instruction : L Type : 反向(Opposite direction) 、H Type : 防水隔熱型(Waterproof and heat insulation)

註一：供應電壓如下：單相(1 Phase)—100, 110, 120, 200, 220, 230, 240V

(Note 1) 三相(3 Phase)—200, 208, 220, 230, 240, 346, 380, 400, 415, 440, 480, 575V

PS：訂購時請指定電壓與頻率。 When ordering, please specify voltage and frequency.

60

BLOTEK 送排風機

<http://www.blotek.com.tw>