

BPA SERIES

BPA-0050

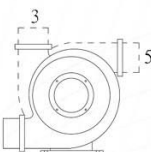

標準型 1
Standard

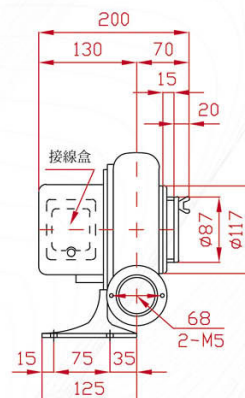
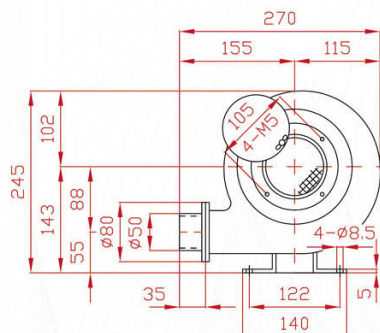

BPA-0080

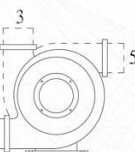

標準型 1
Standard

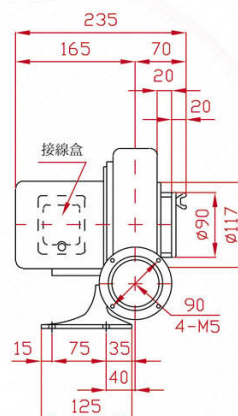
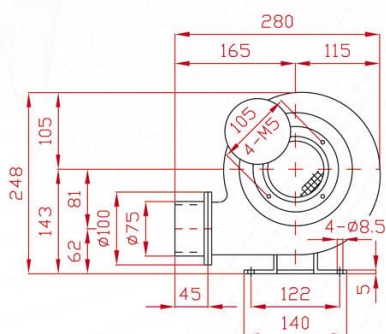

SPECIFICATIONS

型號 TYPE	功率 KW	出口口徑 MM	電壓 V	頻率 HZ	回轉數 R.P.M.	靜壓 mmAq	最大風量 M ³ /MIN	噪音值 dB(A)	淨重 KG(N.W.)
BPA-0050	0.05	φ 50	請指定電壓，註一 (Note 1)	50	2800	40	2.2	45	4.7
BPA-0050L				60	3300	60	2.6	50	
BPA-0050H									5.7
BPA-0080	0.08	φ 75	請指定電壓，註一 (Note 1)	50	2800	65	4.9	60	5
BPA-0080L				60	3300	85	5.3	65	
BPA-0080H									6

說明 Instruction : L Type : 反向(Opposite direction) 、H Type : 防水隔熱型(Waterproof and heat insulation)

BPA-0050L



BPA-0050H

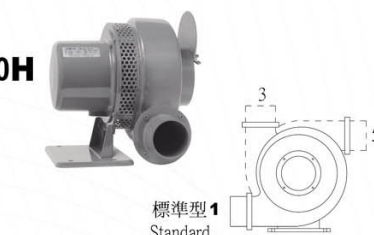

1 標準型
Standard

標準型 1
Standard

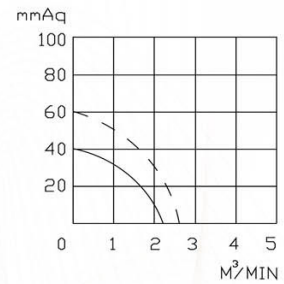
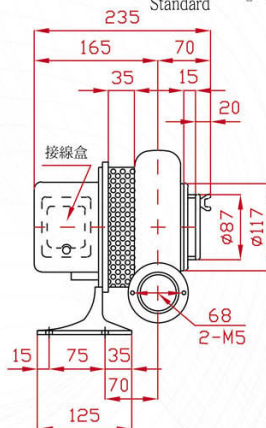
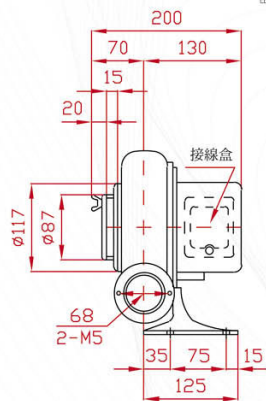

50HZ —
60HZ - - -

BPA-0080L



BPA-0080H



1 標準型
Standard

標準型 1
Standard

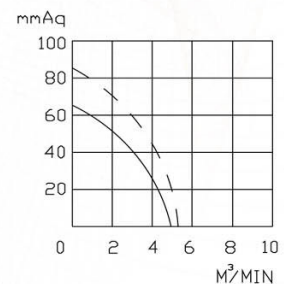
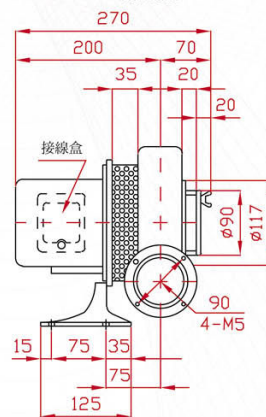
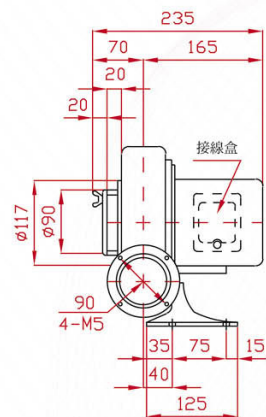

50HZ —
60HZ - - -

註一：供應電壓如下：單相(1 Phase)—100, 110, 120, 200, 220, 230, 240V
(Note 1) 三相(3 Phase)—200, 208, 220, 230, 240, 346, 380, 400, 415, 440, 480, 575V

PS：訂購時請指定電壓與頻率。
When ordering, please specify voltage and frequency.

BPA SERIES

BPA-0100

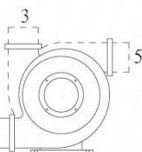

標準型 1
Standard

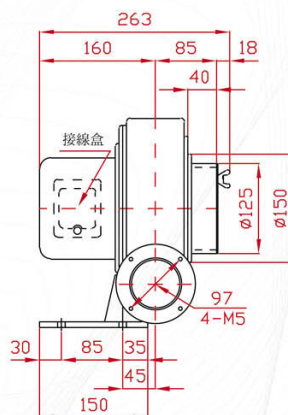
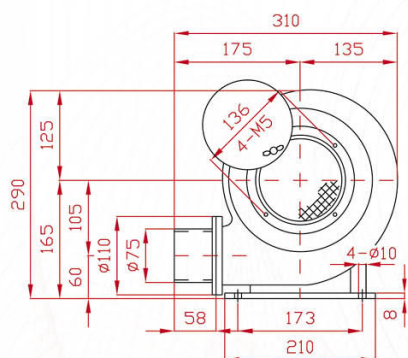

BPA-0200

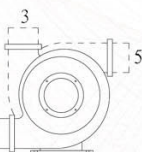

標準型 1
Standard

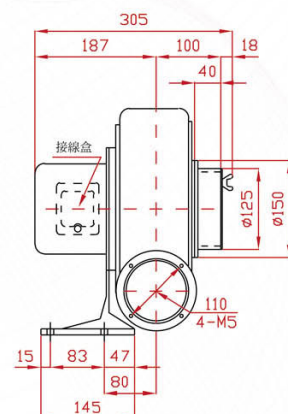
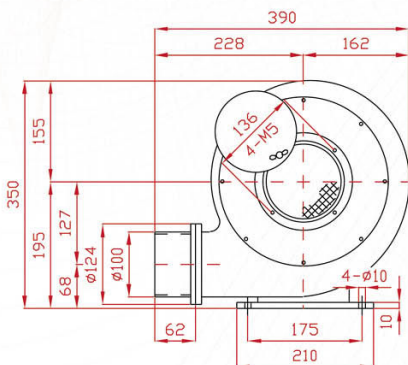

SPECIFICATIONS

型號 TYPE	功率 KW	出口口徑 MM	電壓 V	頻率 HZ	回轉數 R.P.M.	靜壓 mmAq	最大風量 M ³ /MIN	噪音值 dB(A)	淨重 KG(N.W.)
BPA-0100	0.1	φ 75	請指定電壓，註一 (Note 1)	50	2800	70	5.5	65	8.1
BPA-0100L				60	3300	100	6.5	70	
BPA-0100H									9.1
BPA-0200	0.2	φ 100	請指定電壓，註一 (Note 1)	50	2800	104	9.0	70	10
BPA-0200L				60	3300	150	10.5	75	11
BPA-0200H									

說明 Instruction : L Type : 反向(Opposite direction)、H Type : 防水隔熱型(Waterproof and heat insulation)

BPA-0100L

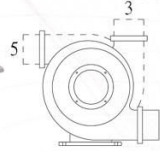

BPA-0100H



標準型
Standard

標準型
Standard

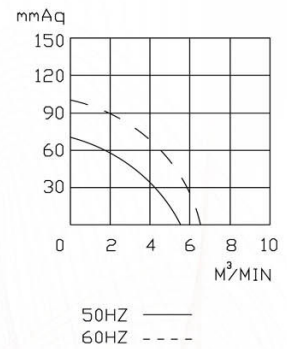
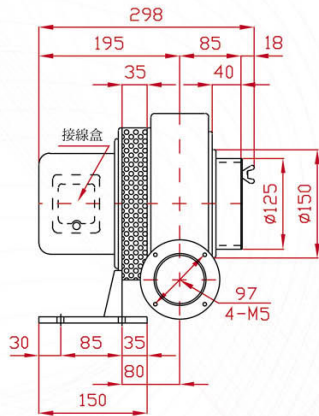
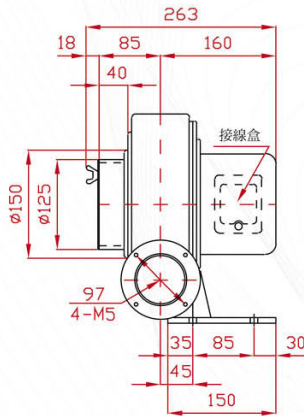

BPA-0200L

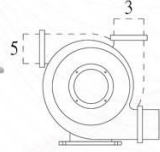

BPA-0200H

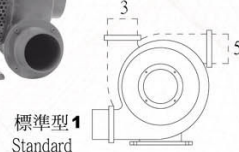

標準型
Standard

標準型
Standard

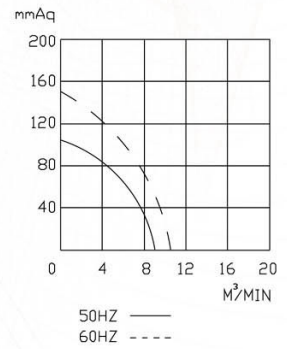
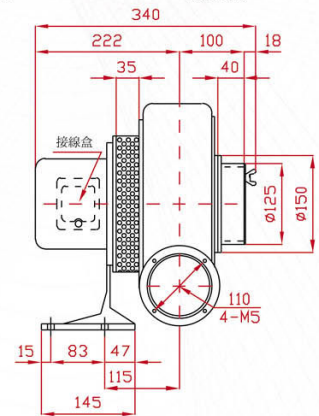
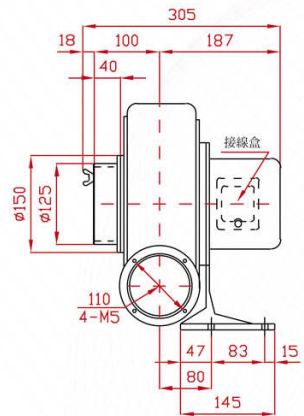

註一：供應電壓如下：單相(1 Phase)—100, 110, 120, 200, 220, 230, 240V
(Note 1) 三相(3 Phase)—200, 208, 220, 230, 240, 346, 380, 400, 415, 440, 480, 575V

PS：訂購時請指定電壓與頻率。
When ordering, please specify voltage and frequency.

BPA SERIES

BPA-0400



標準型 1
Standard

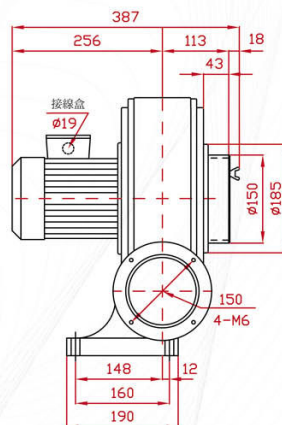
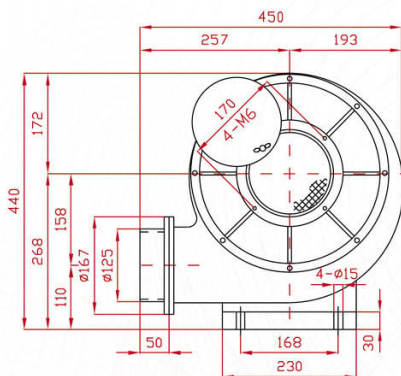
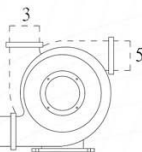

BPA-0400L

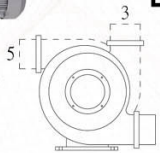

BPA-0400H

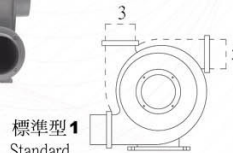

標準型 1
Standard

標準型 1
Standard

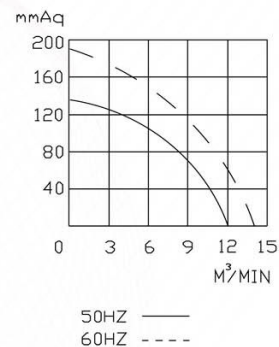
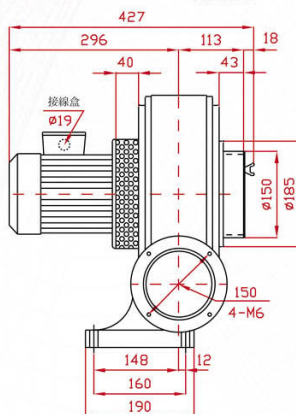
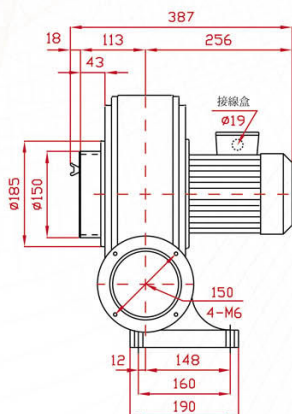

SPECIFICATIONS

型號 TYPE	功率 KW	出口口徑 MM	電壓 V	頻率 HZ	回轉數 R.P.M.	靜壓 mmAq	最大風量 M³/MIN	噪音值 dB(A)	淨重 KG(N.W.)
BPA-0400	0.4	φ 125	請指定電壓，註一 (Note 1)	50	2800	135	12	55	16
BPA-0400L				60	3300	190	14	76	
BPA-0400H									17

說明 Instruction : L Type : 反向(Opposite direction) 、H Type : 防水隔熱型(Waterproof and heat insulation)

註一：供應電壓如下：單相(1 Phase)—100, 110, 120, 200, 220, 230, 240V

(Note 1) 三相(3 Phase)—200, 208, 220, 230, 240, 346, 380, 400, 415, 440, 480, 575V

PS：訂購時請指定電壓與頻率。 When ordering, please specify voltage and frequency.