

BSF SERIES

BSF-0050

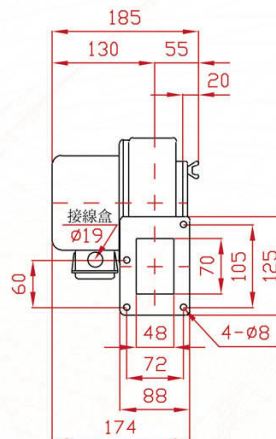

BSFC-0050

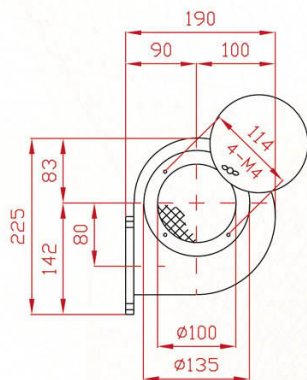
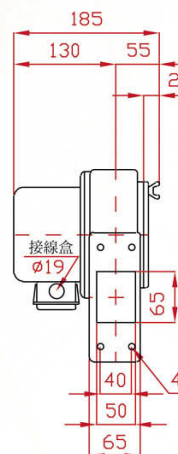
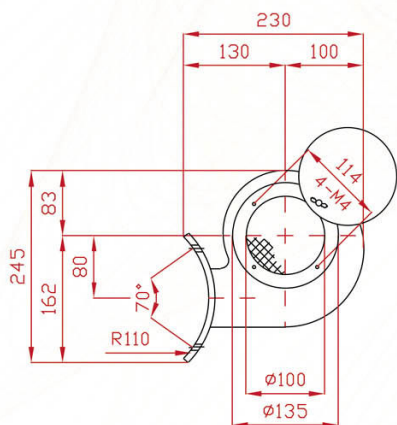

SPECIFICATIONS

| 型號 TYPE | 功率 KW | 出口口徑 MM | 電壓 V | 頻率 HZ | 回轉數 R.P.M. | 靜壓 mmAq | 最大風量 M ³ /MIN | 噪音值 dB(A) | 淨重 KG(N.W.) |
|------------|----------|------------|----------------------|----------|---------------|------------|-----------------------------|--------------|----------------|
| BSF-0050 | 0.05 | 48 x 70 | 請指定電壓，註一 (Note 1) | 50 | 2800 | 30 | 3.0 | 45 | 4.1 |
| BSF-0050L | | | | 60 | 3300 | 46 | 4.5 | 50 | 5.1 |
| BSF-0050H | | | | | | | | | |
| BSFC-0050 | 0.05 | 50 x 65 | 請指定電壓，註一 (Note 1) | 50 | 2800 | 30 | 3.0 | 45 | 4.1 |
| BSFC-0050L | | | | 60 | 3300 | 46 | 4.5 | 50 | 5.1 |
| BSFC-0050H | | | | | | | | | |

說明 Instruction : L Type : 反向(Opposite direction) 、H Type : 防水隔熱型(Waterproof and heat insulation)

BSF-0050L

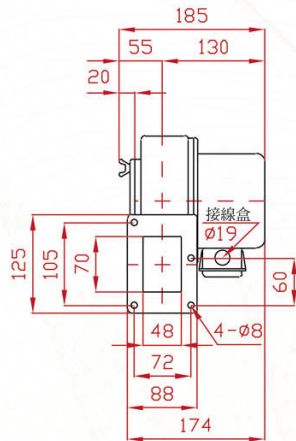

BSF-0050H

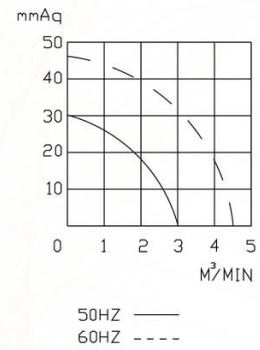
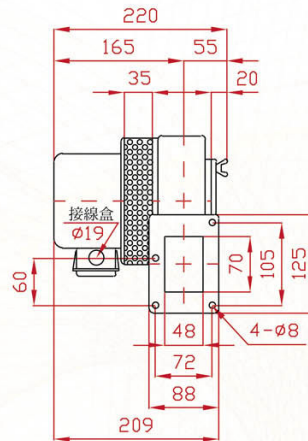

BSFC-0050L

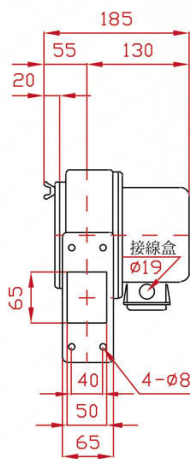

BSFC-0050H

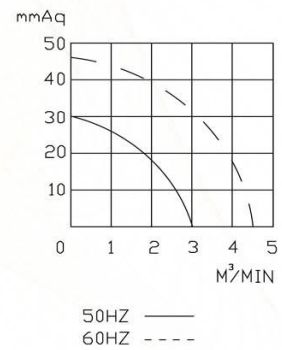
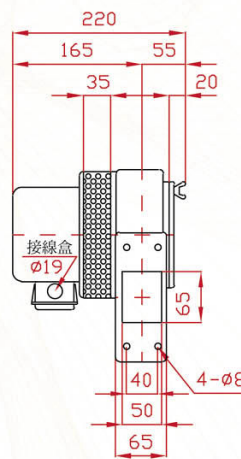

註一：供應電壓如下：單相(1 Phase)—100, 110, 120, 200, 220, 230, 240V
(Note 1) 三相(3 Phase)—200, 208, 220, 230, 240, 346, 380, 400, 415, 440, 480, 575V

PS：訂購時請指定電壓與頻率。
When ordering, please specify voltage and frequency.

BSF SERIES

BSF-0200

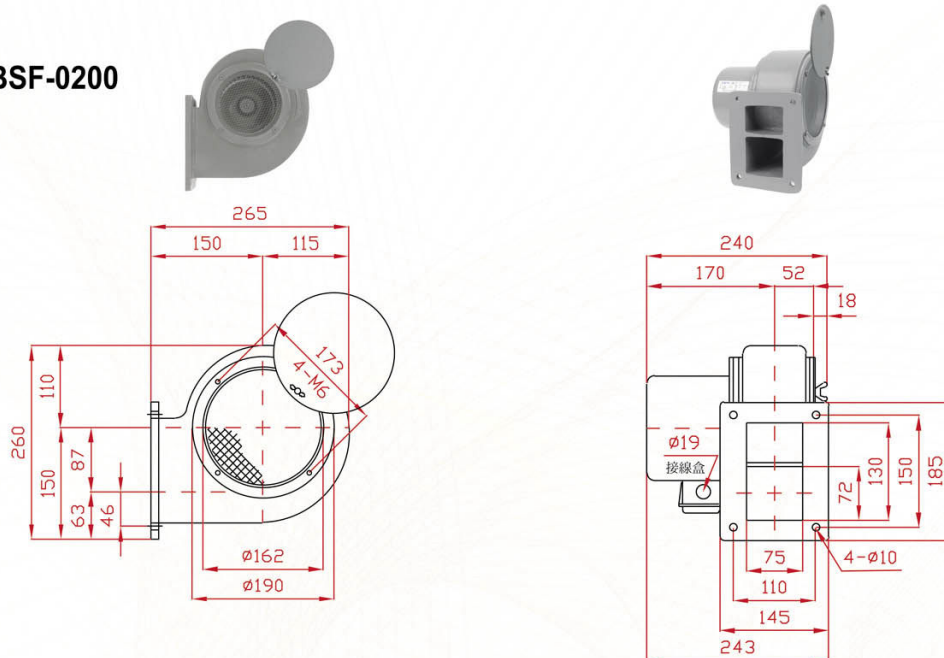

BSF-0400

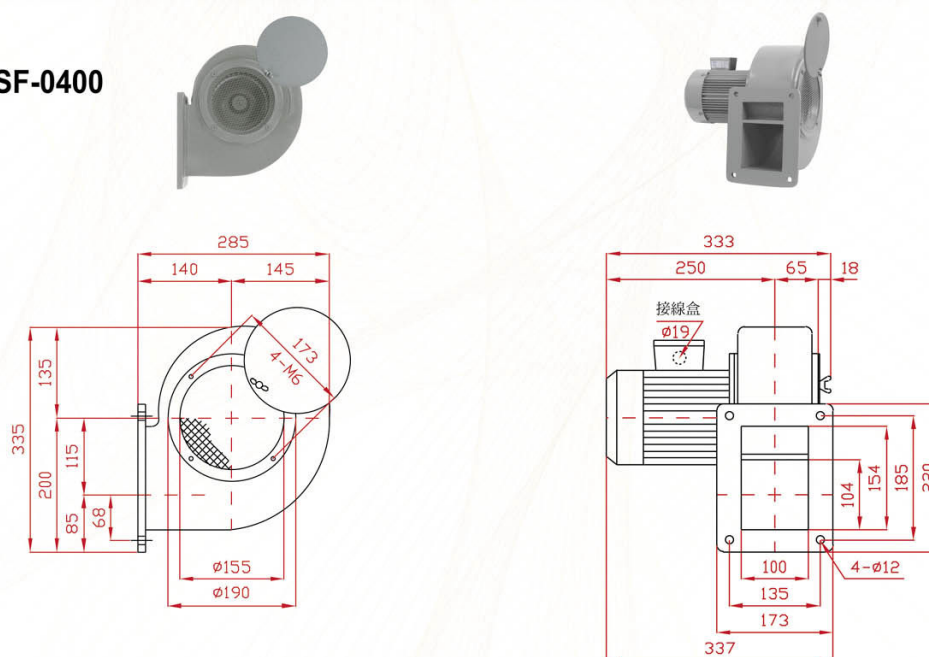

SPECIFICATIONS

| 型號 TYPE | 功率 KW | 出口口徑 MM | 電壓 V | 頻率 HZ | 回轉數 R.P.M. | 靜壓 mmAq | 最大風量 M ³ /MIN | 噪音值 dB(A) | 淨重 KG(N.W.) |
|------------|----------|------------|----------------------|----------|---------------|------------|-----------------------------|--------------|----------------|
| BSF-0200 | 0.2 | 75 x 72 | 請指定電壓，註一 (Note 1) | 50 | 2800 | 60 | 6.5 | 60 | 8 |
| BSF-0200L | | | | 60 | 3300 | 80 | 7.8 | 65 | 9 |
| BSF-0200H | | | | | | | | | |
| BSF-0400 | 0.4 | 100 x 104 | 請指定電壓，註一 (Note 1) | 50 | 2800 | 65 | 15 | 65 | 13 |
| BSF-0400L | | | | 60 | 3300 | 85 | 18 | 70 | 14 |
| BSF-0400H | | | | | | | | | |

說明 Instruction : L Type : 反向(Opposite direction) 、H Type : 防水隔熱型(Waterproof and heat insulation)

BSF-0200L



BSF-0200H

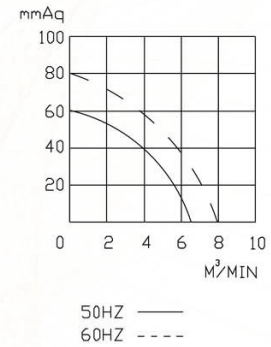
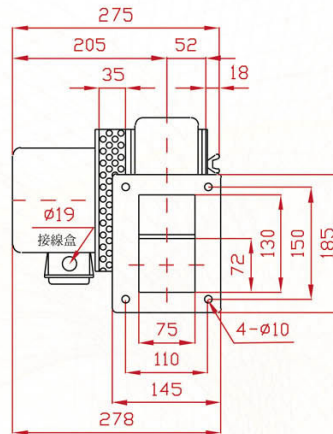
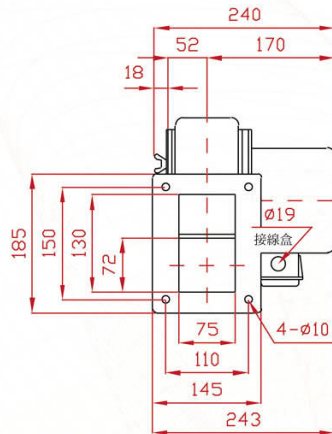

BSF-0400L



BSF-0400H

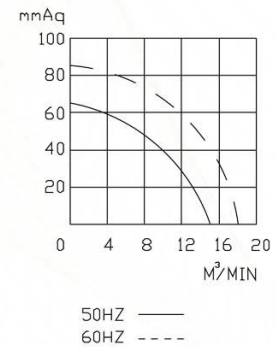
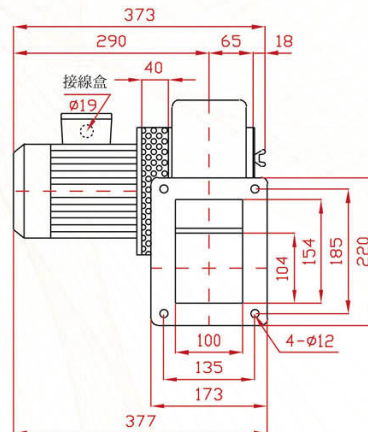
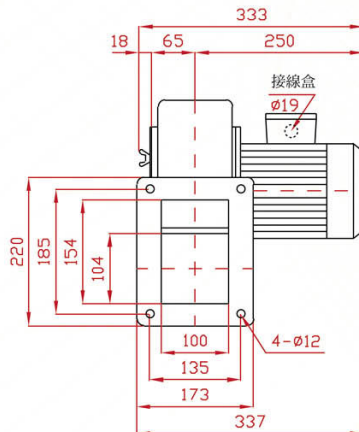
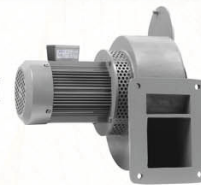

註一：供應電壓如下：單相(1 Phase)—100, 110, 120, 200, 220, 230, 240V
(Note 1) 三相(3 Phase)—200, 208, 220, 230, 240, 346, 380, 400, 415, 440, 480, 575V

PS：訂購時請指定電壓與頻率。
When ordering, please specify voltage and frequency.

BSF SERIES

BSF-0750

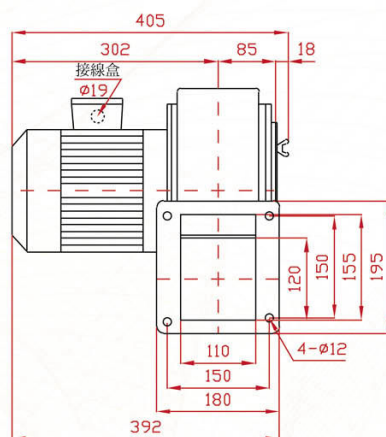
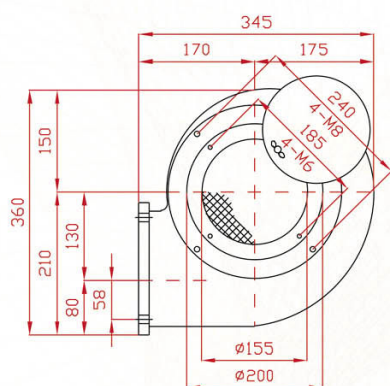

BSF-1500

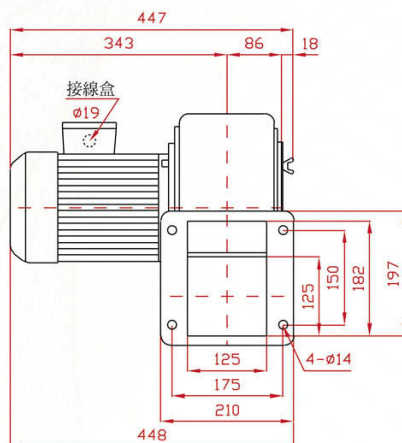
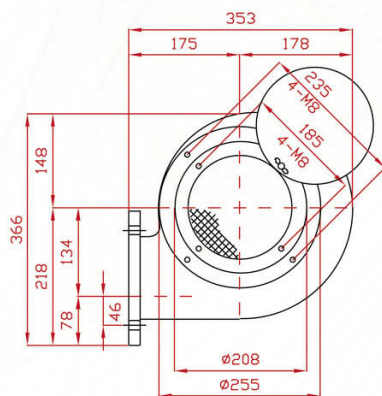

SPECIFICATIONS

| 型號 TYPE | 功率 KW | 出口口徑 MM | 電壓 V | 頻率 HZ | 回轉數 R.P.M. | 靜壓 mmAq | 最大風量 M ³ /MIN | 噪音值 dB(A) | 淨重 KG(N.W.) |
|------------|----------|------------|----------------------|----------|---------------|------------|-----------------------------|--------------|----------------|
| BSF-0750 | 0.75 | 110 x 120 | 請指定電壓，註一 (Note 1) | 50 | 2800 | 120 | 17 | 68 | 20 |
| BSF-0750L | | | | 60 | 3300 | 190 | 20 | 72 | 21 |
| BSF-0750H | | | | | | | | | |
| BSF-1500 | 1.5 | 125 x 125 | 請指定電壓，註二 (Note 2) | 50 | 2800 | 95 | 25 | | 31 |
| BSF-1500L | | | | 60 | 3300 | 115 | 30 | | 32 |
| BSF-1500H | | | | | | | | | |

說明 Instruction : L Type : 反向(Opposite direction) 、H Type : 防水隔熱型(Waterproof and heat insulation)

BSF-0750L



BSF-0750H

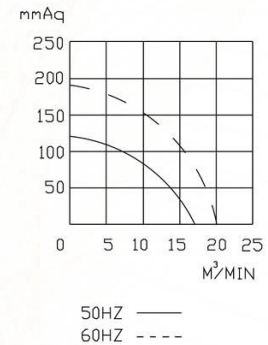
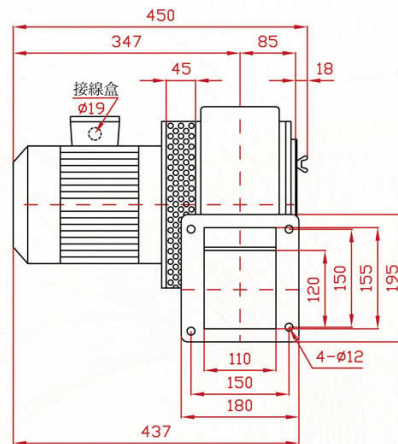
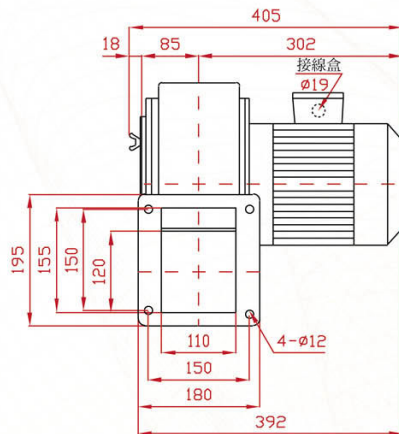

BSF-1500L



BSF-1500H

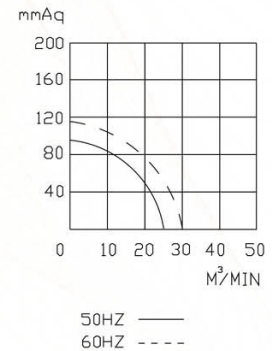
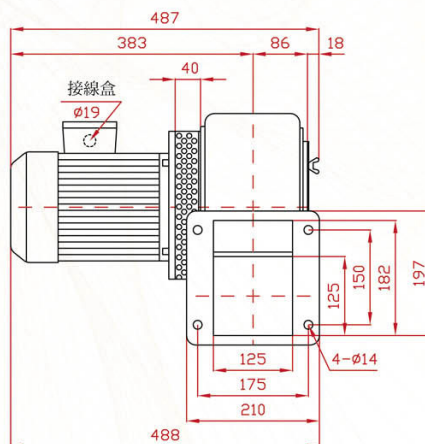
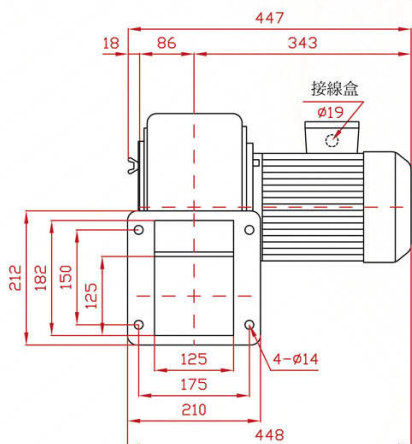

註一：供應電壓如下：單相(1 Phase)—100, 110, 120, 200, 220, 230, 240V
(Note 1) 三相(3 Phase)—200, 208, 220, 230, 240, 346, 380, 400, 415, 440, 480, 575V

註二：供應電壓如下：三相(3 Phase)—200, 208, 220, 230, 240, 346, 380, 400, 415, 440, 480, 575V
(Note 2)

PS：訂購時請指定電壓與頻率。

When ordering, please specify voltage and frequency.

BSF SERIES

BSF-2200

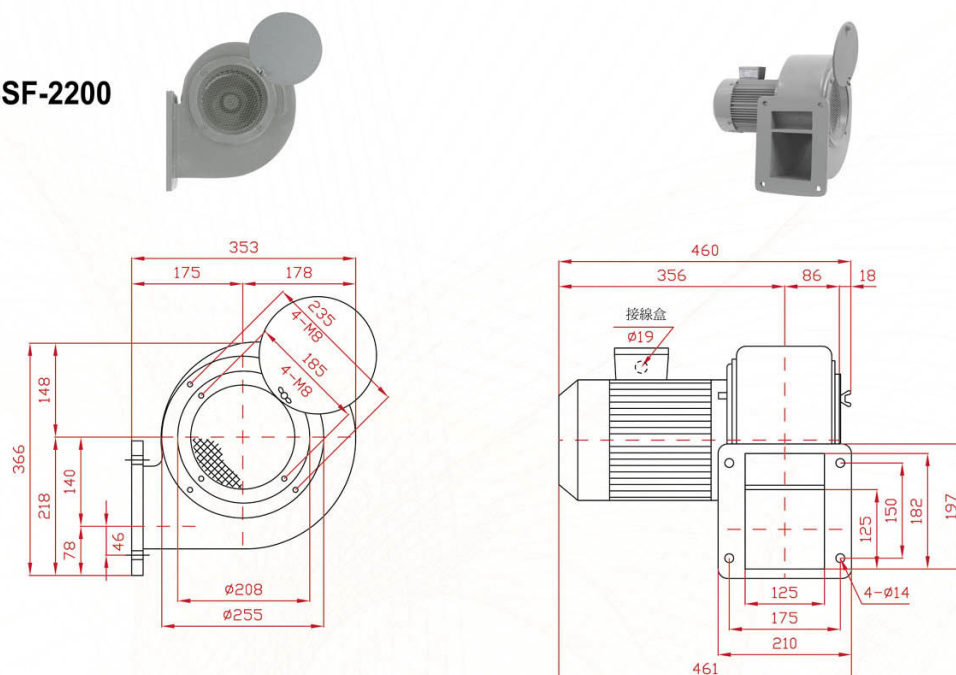

BSFW-0050

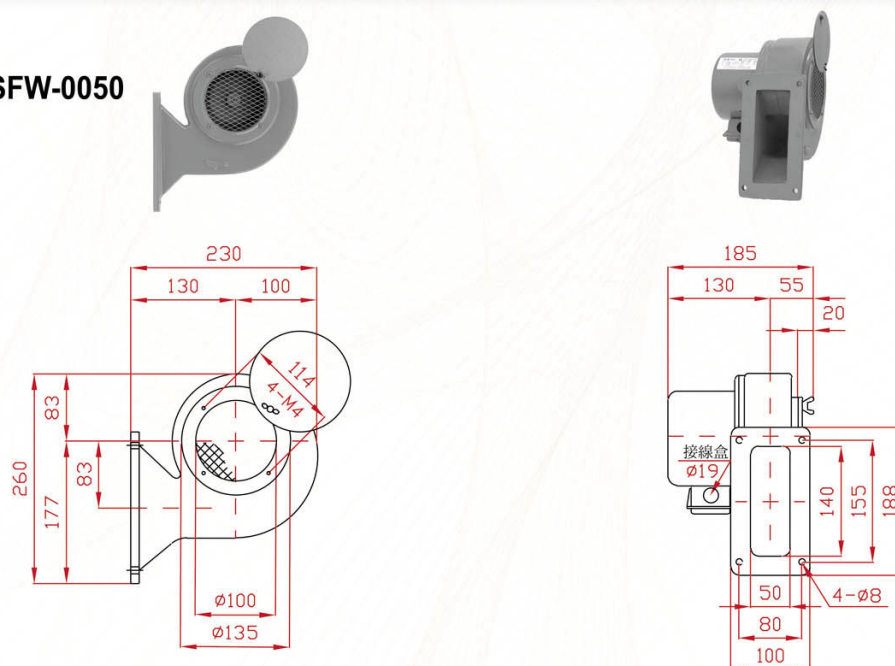

SPECIFICATIONS

| 型號 TYPE | 功率 KW | 出口口徑 MM | 電壓 V | 頻率 HZ | 回轉數 R.P.M. | 靜壓 mmAq | 最大風量 M ³ /MIN | 噪音值 dB(A) | 淨重 KG(N.W.) |
|------------|----------|------------|----------------------|----------|---------------|------------|-----------------------------|--------------|----------------|
| BSF-2200 | 2.2 | 125 x 125 | 請指定電壓，註二 (Note 2) | 50 | 2800 | 102 | 32.8 | | 31 |
| BSF-2200L | | | | 60 | 3300 | 146 | 40 | | 32 |
| BSF-2200H | | | | | | | | | |
| BSFW-0050 | 0.05 | 50 x 140 | 請指定電壓，註一 (Note 1) | 50 | 2800 | 40 | 2.2 | 45 | 4.5 |
| BSFW-0050L | | | | 60 | 3300 | 60 | 2.6 | 50 | 5.5 |
| BSFW-0050H | | | | | | | | | |

說明 Instruction : L Type : 反向(Opposite direction) 、H Type : 防水隔熱型(Waterproof and heat insulation)

BSF-2200L



BSF-2200H

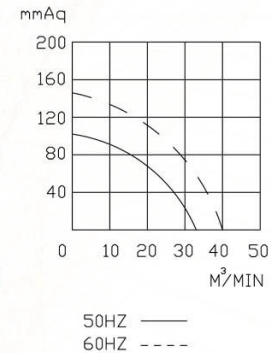
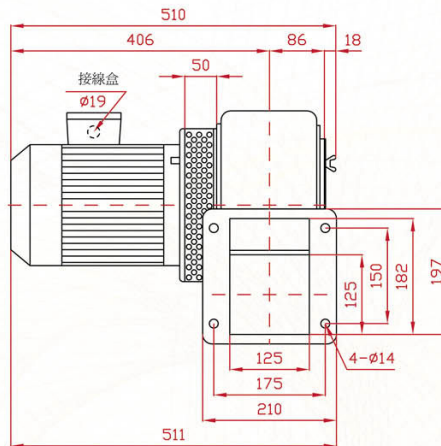
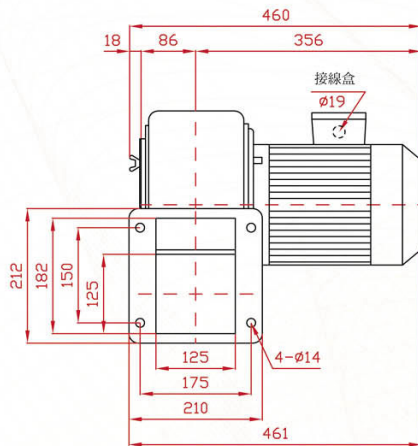

BSFW-0050L



BSFW-0050H

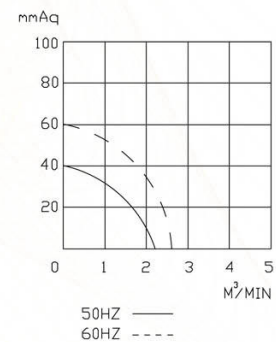
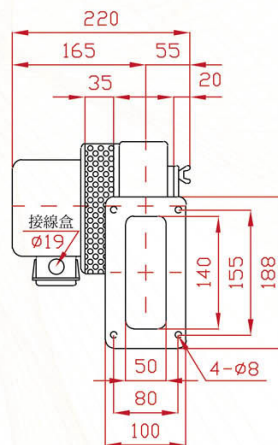
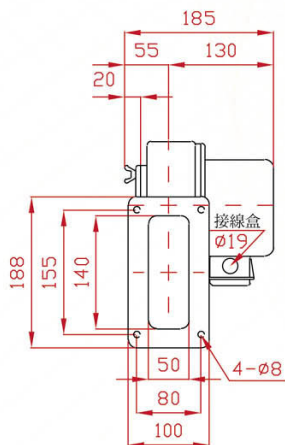

註一：供應電壓如下：單相(1 Phase)—100, 110, 120, 200, 220, 230, 240V
(Note 1) 三相(3 Phase)—200, 208, 220, 230, 240, 346, 380, 400, 415, 440, 480, 575V

註二：供應電壓如下：三相(3 Phase)—200, 208, 220, 230, 240, 346, 380, 400, 415, 440, 480, 575V
(Note 2)

PS：訂購時請指定電壓與頻率。

When ordering, please specify voltage and frequency.

BSF SERIES

BSFW-0100

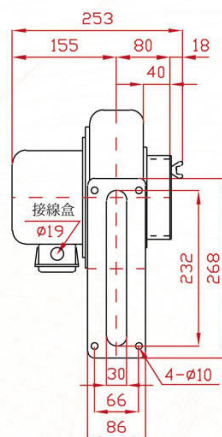
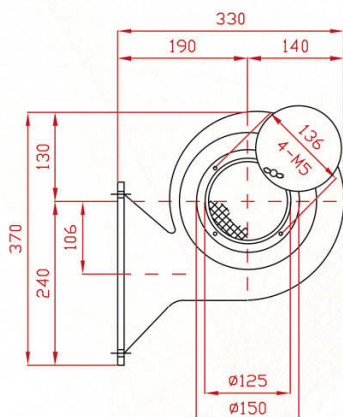

BSFW-0200

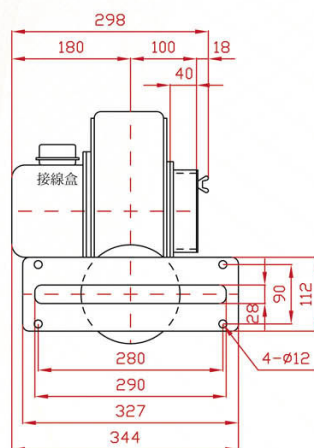
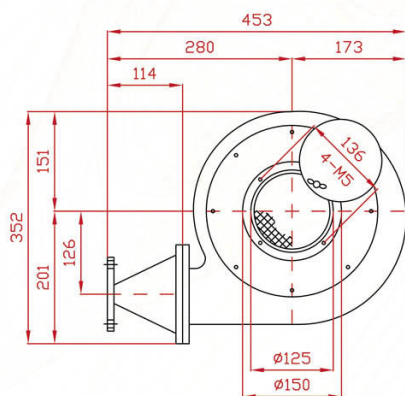

SPECIFICATIONS

| 型號 TYPE | 功率 KW | 出口口徑 MM | 電壓 V | 頻率 HZ | 回轉數 R.P.M. | 靜壓 mmAq | 最大風量 M ³ /MIN | 噪音值 dB(A) | 淨重 KG(N.W.) |
|------------|----------|------------|----------------------|----------|---------------|------------|-----------------------------|--------------|----------------|
| BSFW-0100 | 0.1 | 30 x 232 | 請指定電壓，註一 (Note 1) | 50 | 2800 | 70 | 5.5 | 45 | 8.2 |
| BSFW-0100L | | | | 60 | 3300 | 100 | 6.5 | 50 | |
| BSFW-0200 | 0.2 | 28 x 290 | 請指定電壓，註一 (Note 1) | 50 | 2800 | 104 | 9.0 | 70 | 10 |
| BSFW-0200L | | | | 60 | 3300 | 150 | 10.5 | 75 | |

說明 Instruction : L Type : 反向(Opposite direction) 、H Type : 防水隔熱型(Waterproof and heat insulation)

BSFW-0100L

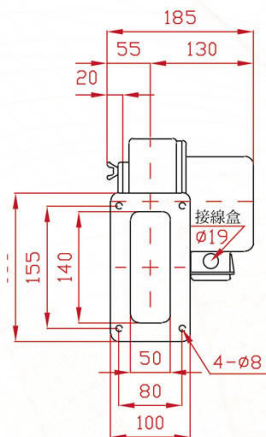

BSFW-0100H



如有需要此產品，請與本公司營業部人員聯絡。

"If you wish to have this product, please contact with our sales staff with thanks"

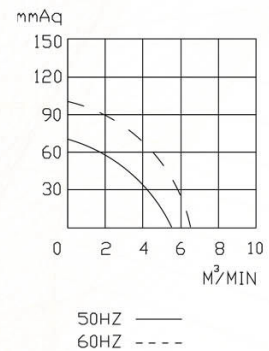

BSFW-0200L

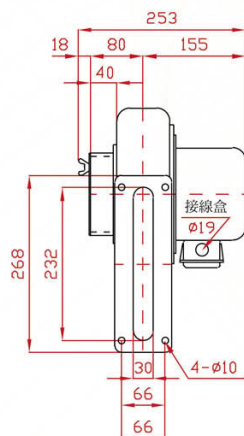

BSFW-0200H



如有需要此產品，請與本公司營業部人員聯絡。

"If you wish to have this product, please contact with our sales staff with thanks"

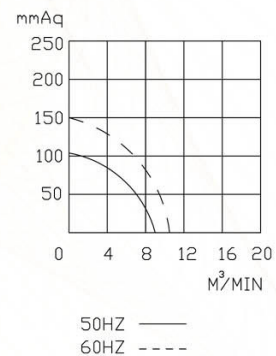

註一：供應電壓如下：單相(1 Phase)—100, 110, 120, 200, 220, 230, 240V
(Note 1) 三相(3 Phase)—200, 208, 220, 230, 240, 346, 380, 400, 415, 440, 480, 575V

PS：訂購時請指定電壓與頻率。
When ordering, please specify voltage and frequency.