

BTE SERIES

BTE-0750

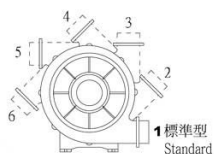

標準型 1
Standard

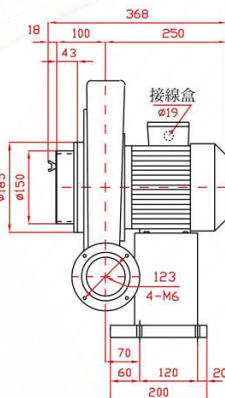
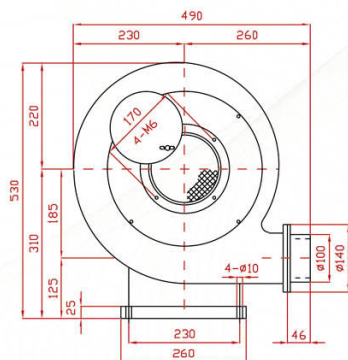

BTE-0750L

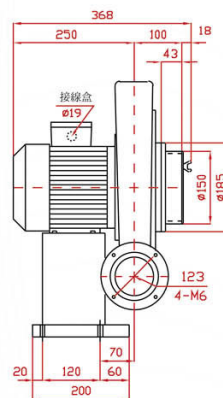
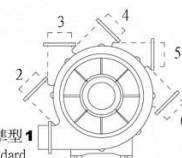

BTE-1500

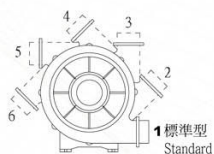

標準型 1
Standard

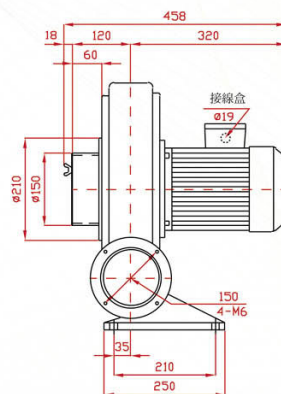
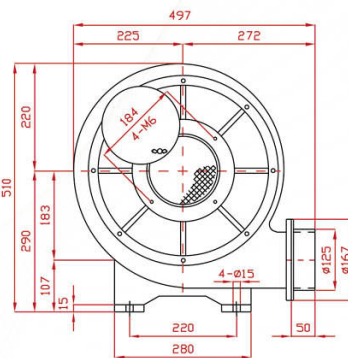

BTE-1500L

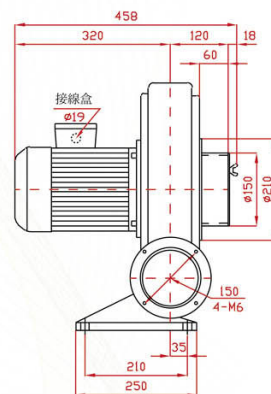
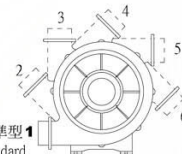

SPECIFICATIONS

| 型號 TYPE | 功率 KW | 出口口徑 MM | 電壓 V | 頻率 HZ | 回轉數 R.P.M. | 靜壓 mmAq | 最大風量 M ³ /MIN | 噪音值 dB(A) | 淨重 KG(N.W.) |
|------------|----------|------------|----------------------|----------|---------------|------------|-----------------------------|--------------|----------------|
| BTE-0750 | 0.75 | φ 100 | 請指定電壓，註一 (Note 1) | 50 | 2800 | 190 | 21 | 58 | 28 |
| BTE-0750L | | | | 60 | 3300 | 210 | 25 | 80 | 29 |
| BTE-0750C | | | | | | | | | 31.5 |
| BTE-1500 | 1.5 | φ 125 | 請指定電壓，註二 (Note 2) | 50 | 2800 | 200 | 24 | 60 | 33 |
| BTE-1500L | | | | 60 | 3300 | 250 | 30 | 82 | 34 |
| BTE-1500C | | | | | | | | | 36.5 |

說明 Instruction: L Type: 反向(Opposite direction)、H Type: 防水隔熱型(Waterproof and heat insulation)、

C Type: 微調入口風門(Micro adjust inlet valve)

BLOTEK 送排風機

<http://www.blotek.com.tw>

BTE-0750H

BTE-0750C

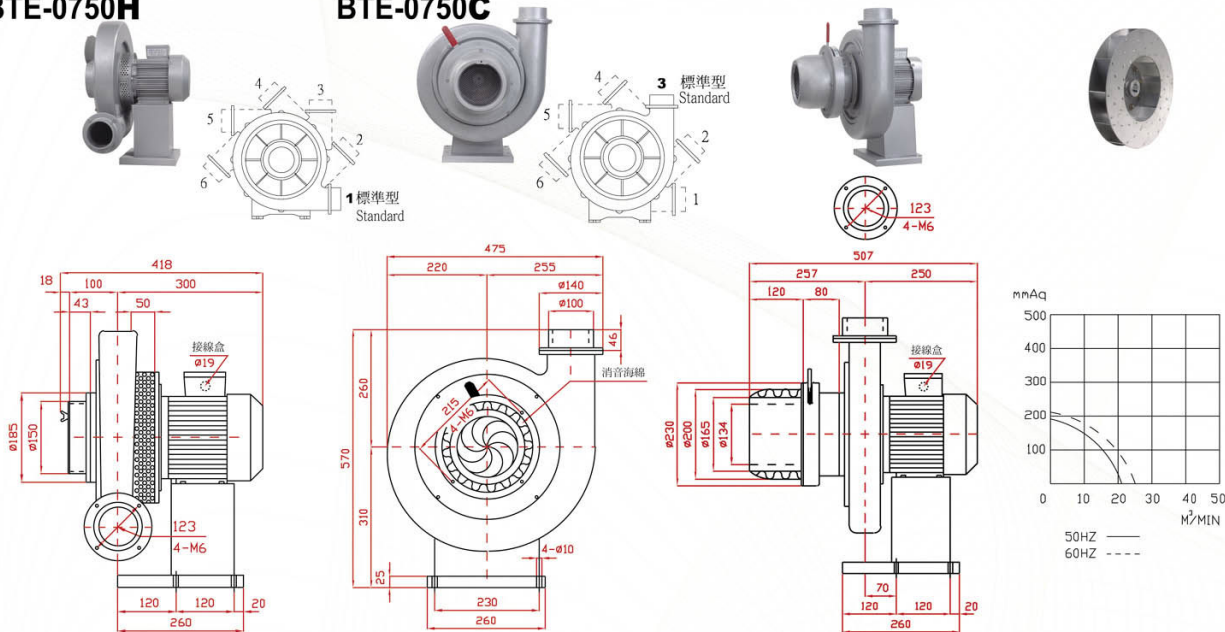

BTE-1500H

BTE-1500C

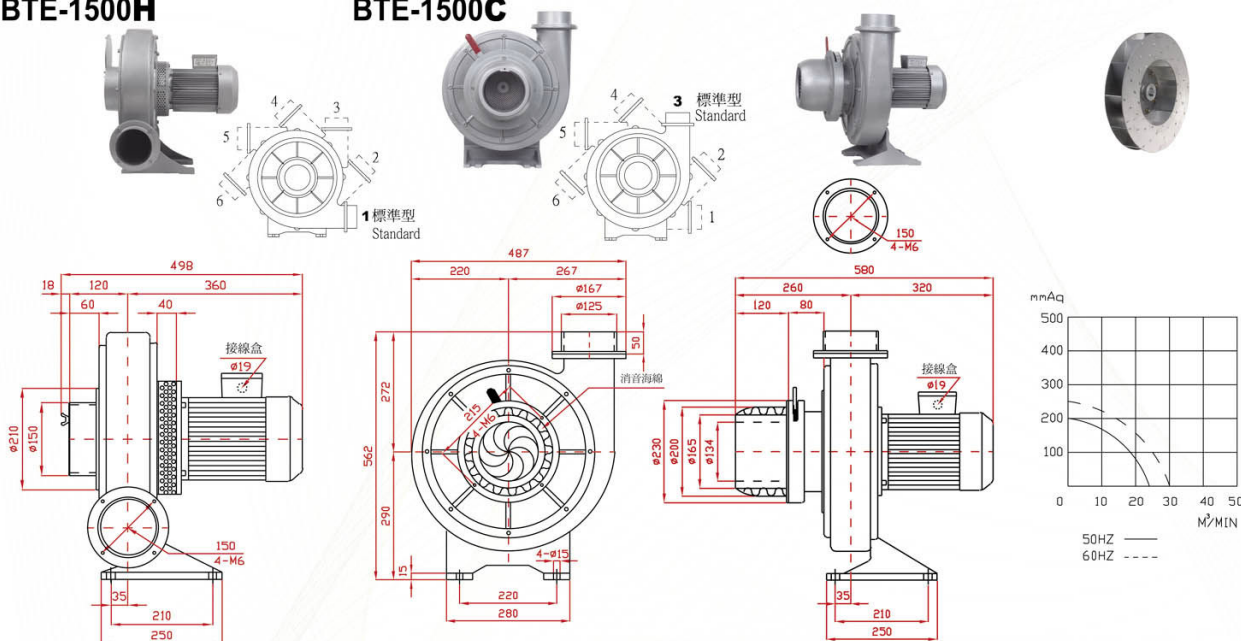

註一：供應電壓如下：單相(1 Phase)—100, 110, 120, 200, 220, 230, 240V
(Note 1) 三相(3 Phase)—200, 208, 220, 230, 240, 346, 380, 400, 415, 440, 480, 575V

註二：供應電壓如下：三相(3 Phase)—200, 208, 220, 230, 240, 346, 380, 400, 415, 440, 480, 575V
(Note 2)

PS：訂購時請指定電壓與頻率。

When ordering, please specify voltage and frequency.

BTE SERIES

BTE-2200

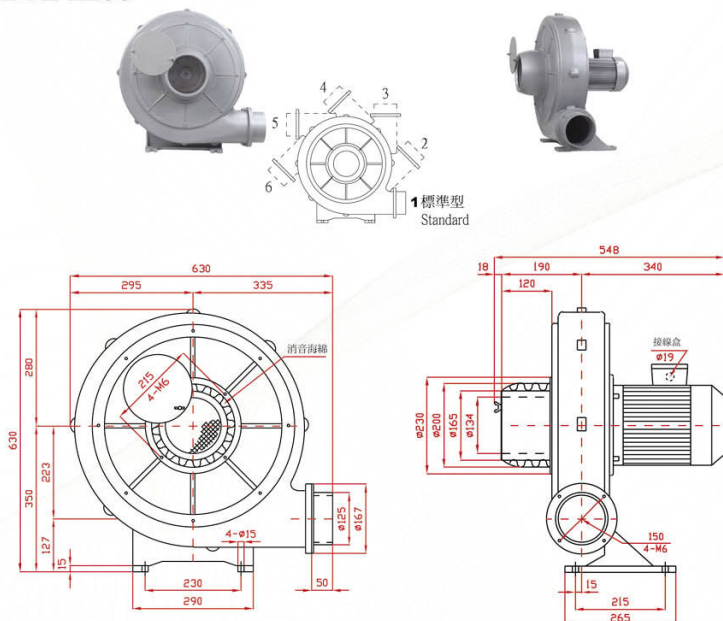

BTE-2200L

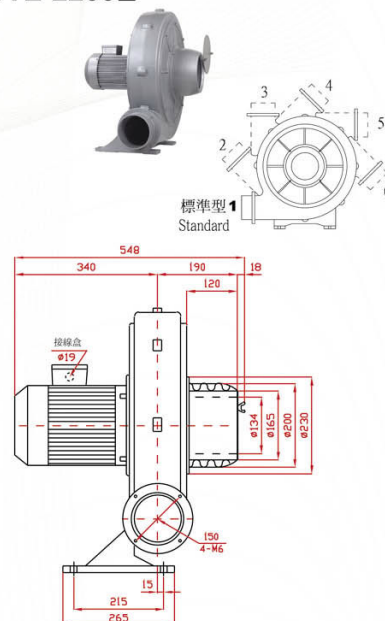

BTE-3700

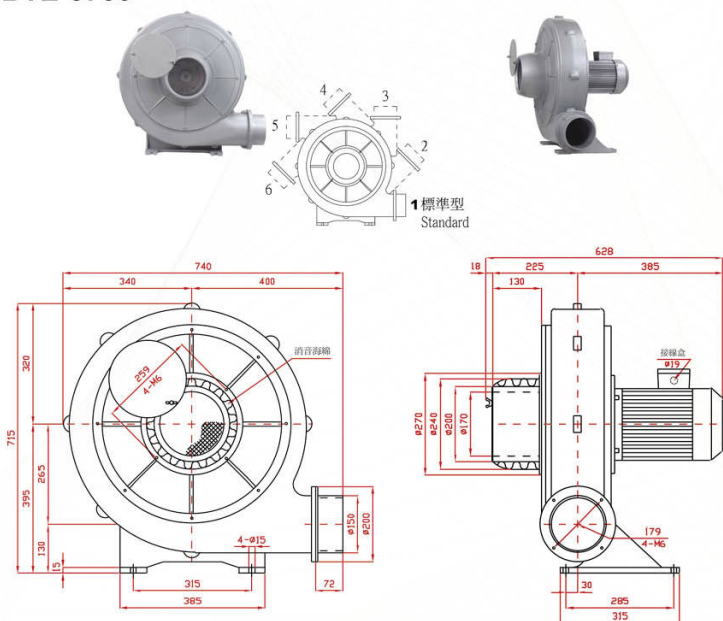

BTE-3700L

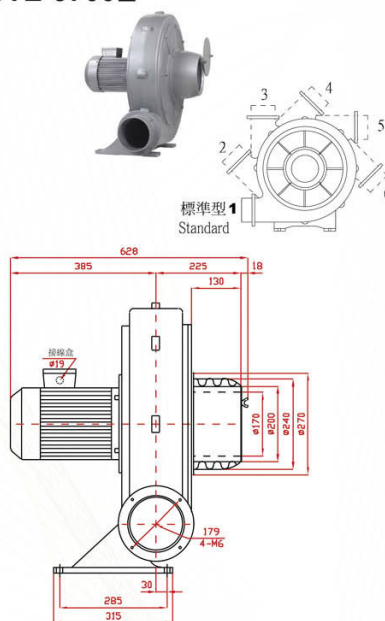

SPECIFICATIONS

| 型號 TYPE | 功率 KW | 出口口徑 MM | 電壓 V | 頻率 HZ | 回轉數 R.P.M. | 靜壓 mmAq | 最大風量 M ³ /MIN | 噪音值 dB(A) | 淨重 KG(N.W.) |
|------------|----------|------------|----------------------|----------|---------------|------------|-----------------------------|--------------|----------------|
| BTE-2200 | 2.2 | φ 125 | 請指定電壓，註二 (Note 2) | 50 | 2800 | 310 | 28 | 63 | 46 |
| BTE-2200L | | | | 60 | 3300 | 340 | 34 | 84 | 47 50.5 |
| BTE-2200H | | | | | | | | | |
| BTE-2200C | | | | | | | | | |
| BTE-3700 | 3.7 | φ 150 | 請指定電壓，註二 (Note 2) | 50 | 2800 | 380 | 36 | 65 | 60 |
| BTE-3700L | | | | 60 | 3300 | 480 | 50 | 87 | 61.5 64.5 |
| BTE-3700H | | | | | | | | | |
| BTE-3700C | | | | | | | | | |

說明 Instruction : L Type : 反向(Opposite direction) 、H Type : 防水隔熱型(Waterproof and heat insulation) 、

C Type : 微調入口風門(Micro adjust inlet valve)

BLOTEK 送排風機 <http://www.blotek.com.tw>

BTE-2200H

BTE-2200C

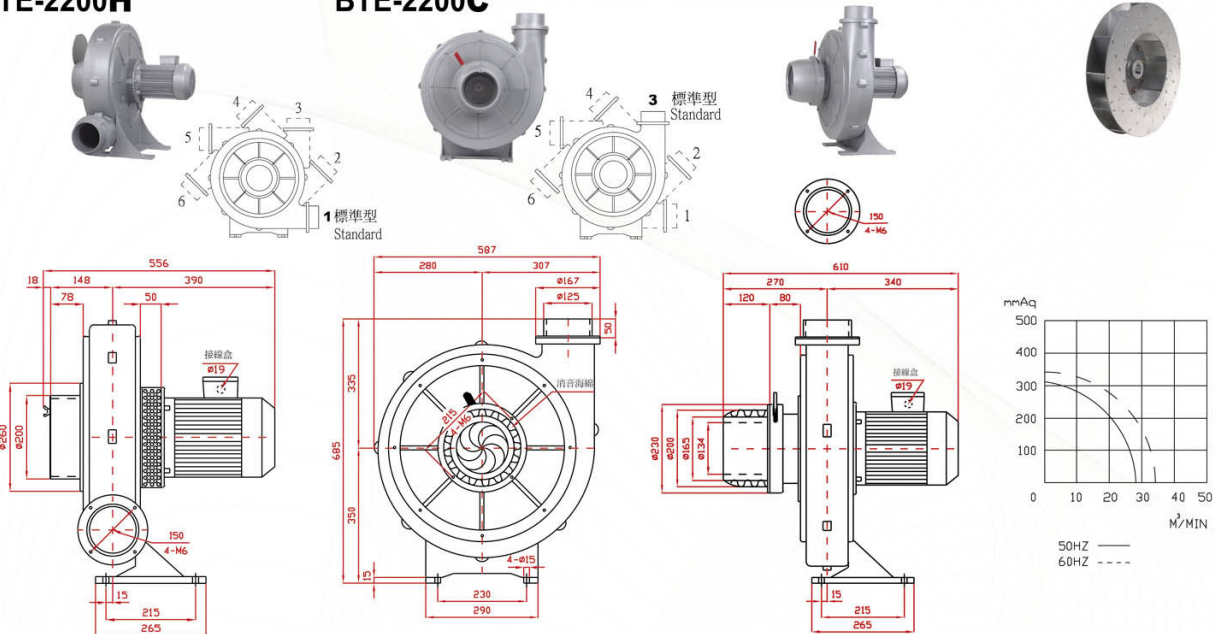

BTE-3700H

BTE-3700C

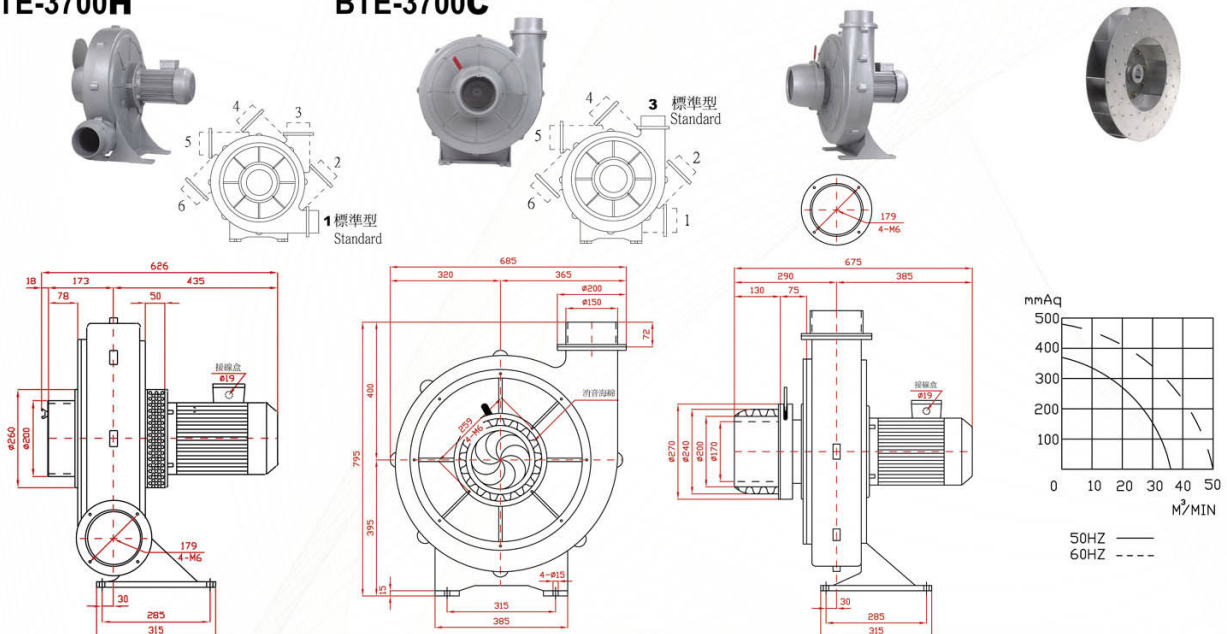

註二：供應電壓如下：三相(3 Phase)—200, 208, 220, 230, 240, 346, 380, 400, 415, 440, 480, 575V (Note 2)

PS：訂購時請指定電壓與頻率。

When ordering, please specify voltage and frequency.

BTE SERIES

BTE-5500

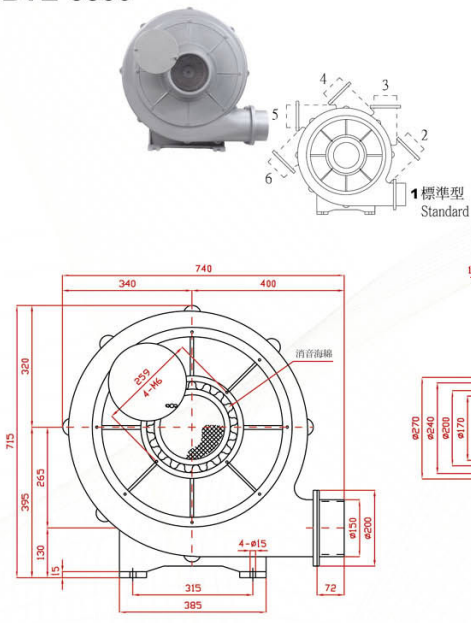

BTE-5500L

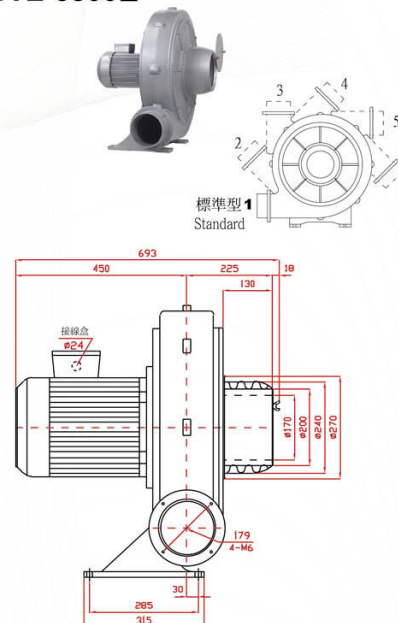

BTE-7500

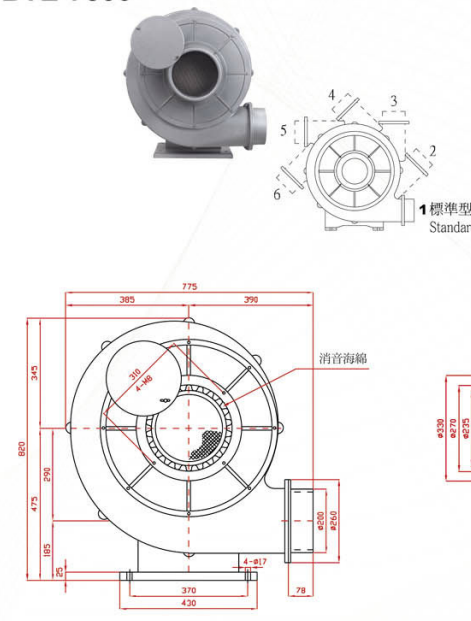

BTE-7500L

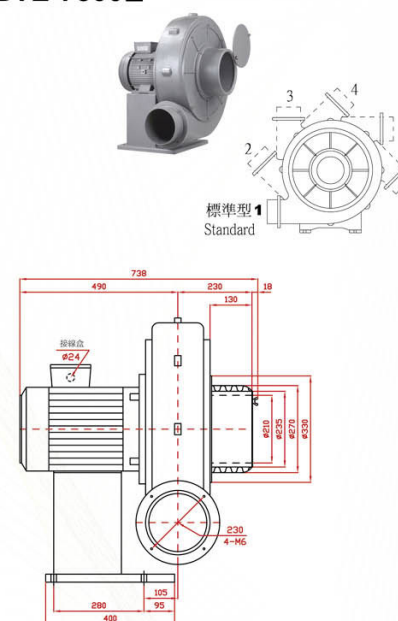

SPECIFICATIONS

| 型號 TYPE | 功率 KW | 出口口徑 MM | 電壓 V | 頻率 HZ | 回轉數 R.P.M. | 靜壓 mmAq | 最大風量 M ³ /MIN | 噪音值 dB(A) | 淨重 KG(N.W.) |
|------------|----------|------------|----------------------|----------|---------------|------------|-----------------------------|--------------|----------------|
| BTE-5500 | 5.5 | φ 150 | 請指定電壓，註二 (Note 2) | 50 | 2800 | 450 | 48 | 70 | 75 |
| BTE-5500L | | | | 60 | 3300 | 530 | 60 | 90 | 76.5 |
| BTE-5500H | | | | | | | | | 79.5 |
| BTE-5500C | | | | | | | | | |
| BTE-7500 | 7.5 | φ 200 | 請指定電壓，註二 (Note 2) | 50 | 2800 | 500 | 60 | 80 | 126 |
| BTE-7500L | | | | 60 | 3300 | 620 | 78 | 95 | 127.5 |
| BTE-7500H | | | | | | | | | 130.5 |
| BTE-7500C | | | | | | | | | |

說明 Instruction : L Type : 反向(Opposite direction) 、H Type : 防水隔熱型(Waterproof and heat insulation) 、

C Type : 微調入口風門(Micro adjust inlet valve)

BLOTEK 送排風機

<http://www.blotek.com.tw>

BTE-5500H

BTE-5500C

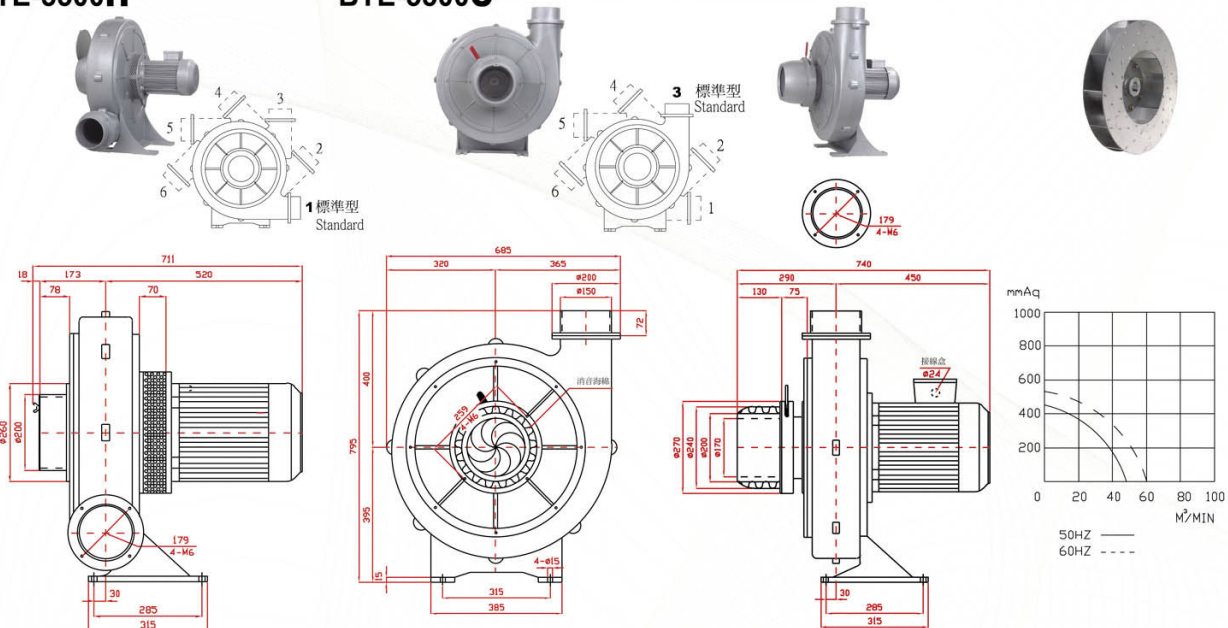

BTE-7500H

BTE-7500C

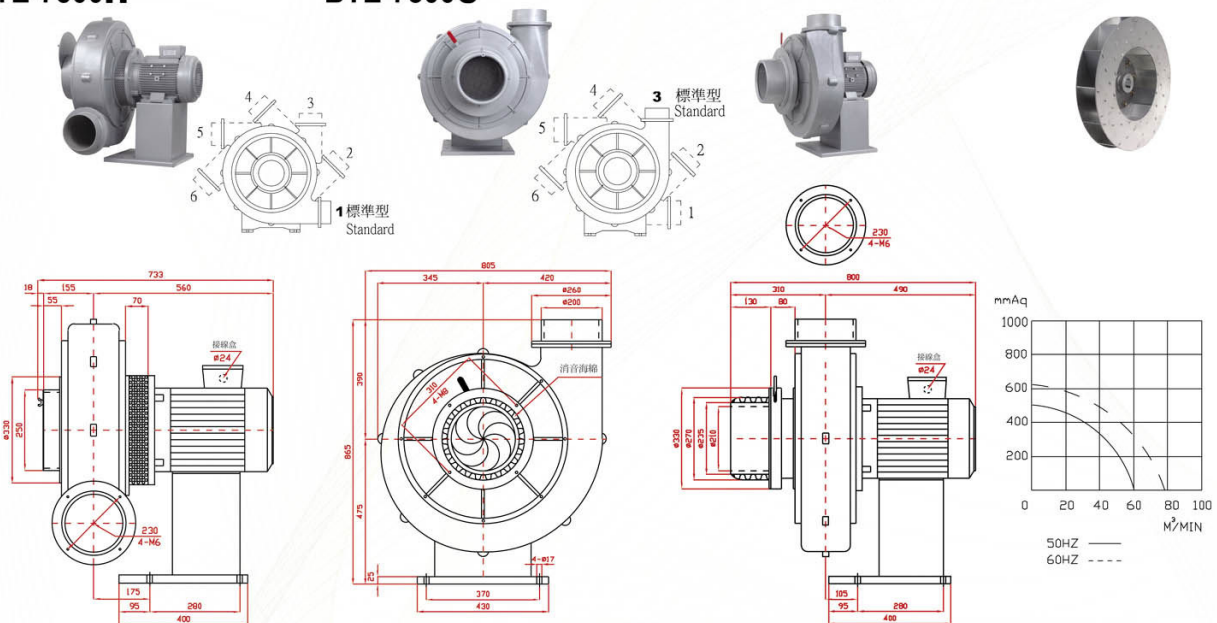

註二：供應電壓如下：三相(3 Phase)—200, 208, 220, 230, 240, 346, 380, 400, 415, 440, 480, 575V
(Note 2)

PS：訂購時請指定電壓與頻率。

When ordering, please specify voltage and frequency.

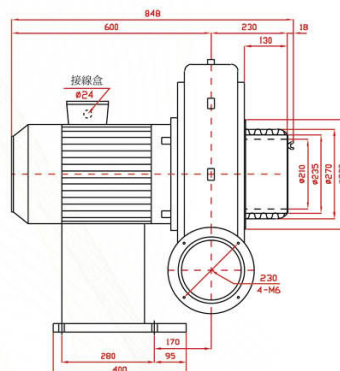
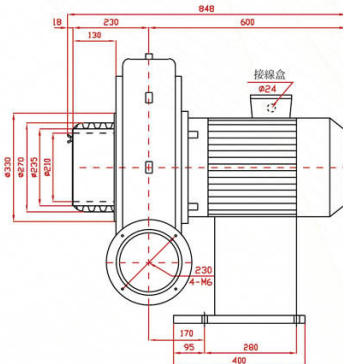
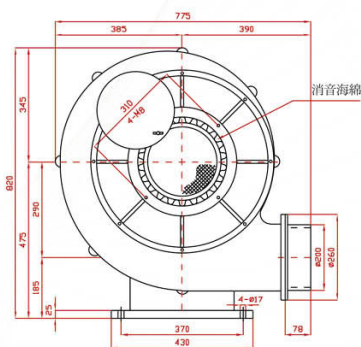
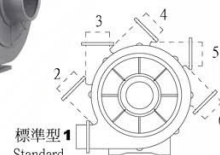
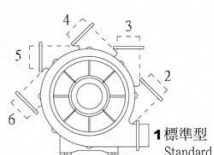
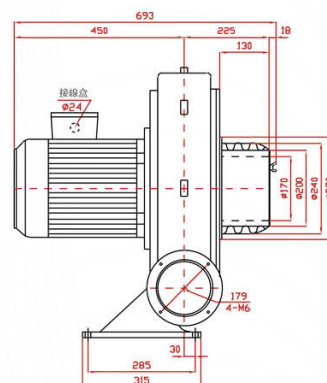
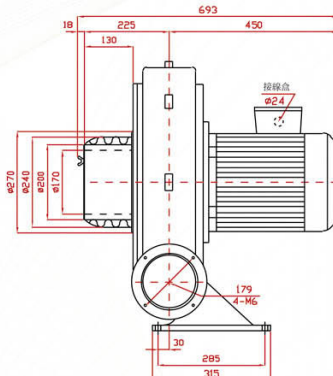
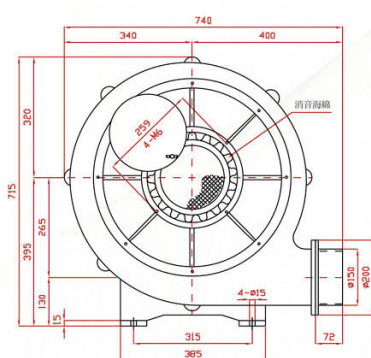
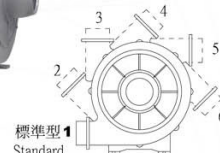
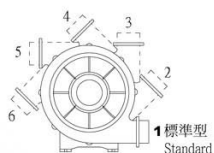

| 型號 | 功率 | 出口口徑 | 電壓 | 頻率 | 回轉數 | 靜壓 | 最大風量 | 噪音值 | 淨重 |
|------------|------|-------|----------------------|----|--------|------|---------------------|-------|----------|
| TYPE | KW | MM | V | HZ | R.P.M. | mmAq | M ³ /MIN | dB(A) | KG(N.W.) |
| BTE-7500A | 7.5 | φ 150 | 請指定電壓，註二 (Note 2) | 50 | 2800 | 500 | 58 | 80 | 87 |
| BTE-7500AL | | | | 60 | 3300 | 620 | 70 | 95 | 88.5 |
| BTE-7500AH | | | | | | | | | 91.5 |
| BTE-7500AC | | | | | | | | | |
| BTE-11KW | 11.2 | φ 200 | 請指定電壓，註二 (Note 2) | 50 | 2800 | 540 | 80 | 89 | 177 |
| BTE-11KWL | | | | 60 | 3300 | 720 | 95 | 105 | 178.5 |
| BTE-11KWH | | | | | | | | | 181.5 |
| BTE-11KWC | | | | | | | | | |

BLOTEK® 送排風機 <http://www.blotek.com.tw>

BTE-7500AH

BTE-7500AC

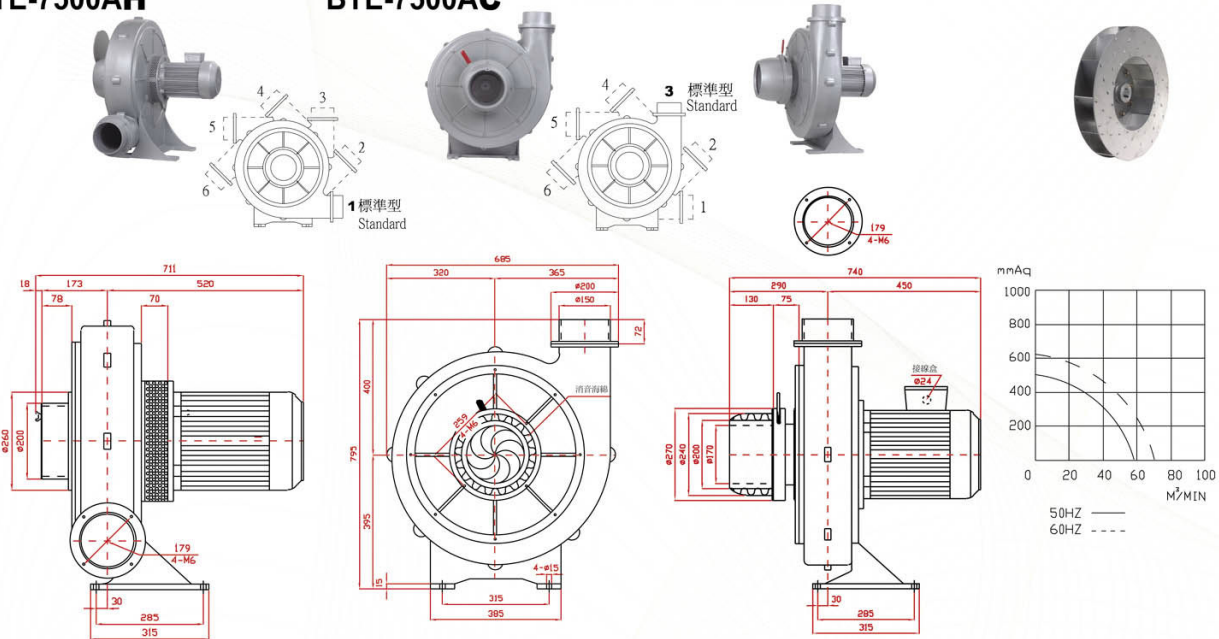

BTE-11KWH

BTE-11KWC

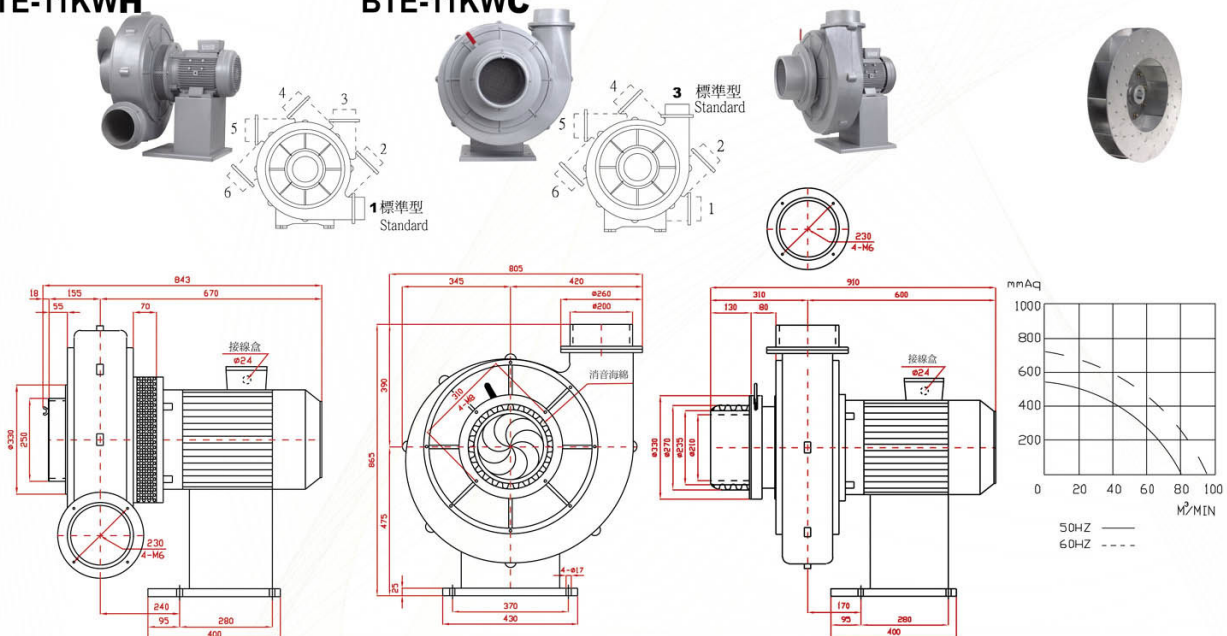

註二：供應電壓如下：三相(3 Phase)—200, 208, 220, 230, 240, 346, 380, 400, 415, 440, 480, 575V
(Note 2)

PS：訂購時請指定電壓與頻率。

When ordering, please specify voltage and frequency.

BTE SERIES

BTE-15KW

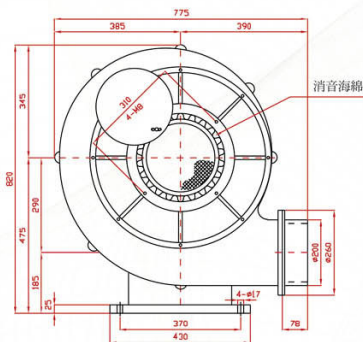
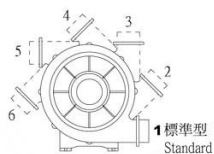

BTE-15KWL

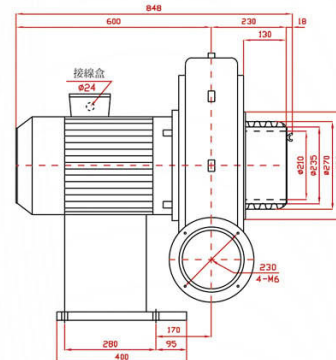
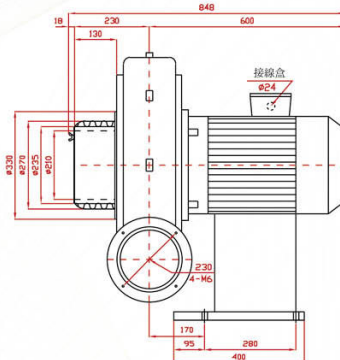

SPECIFICATIONS

| 型號 TYPE | 功率 KW | 出口口徑 MM | 電壓 V | 頻率 HZ | 回轉數 R.P.M. | 靜壓 mmAq | 最大風量 M³/MIN | 噪音值 dB(A) | 淨重 KG(N.W.) |
|------------|----------|------------|----------------------|----------|---------------|------------|----------------|--------------|----------------|
| BTE-15KW | 15 | φ 200 | 請指定電壓，註二 (Note 2) | 50 | 2800 | 600 | 90 | 96 | 195 |
| BTE-15KWL | | | | 60 | 3300 | 780 | 108 | 113 | 196.5 |
| BTE-15KWH | | | | | | | | | 199.5 |

說明 Instruction : **L** Type : 反向(Opposite direction) 、 **H** Type : 防水隔熱型(Waterproof and heat insulation) 、
C Type : 微調入口風門(Micro adjust inlet valve)

BTE-15KWH

BTE-15KWC

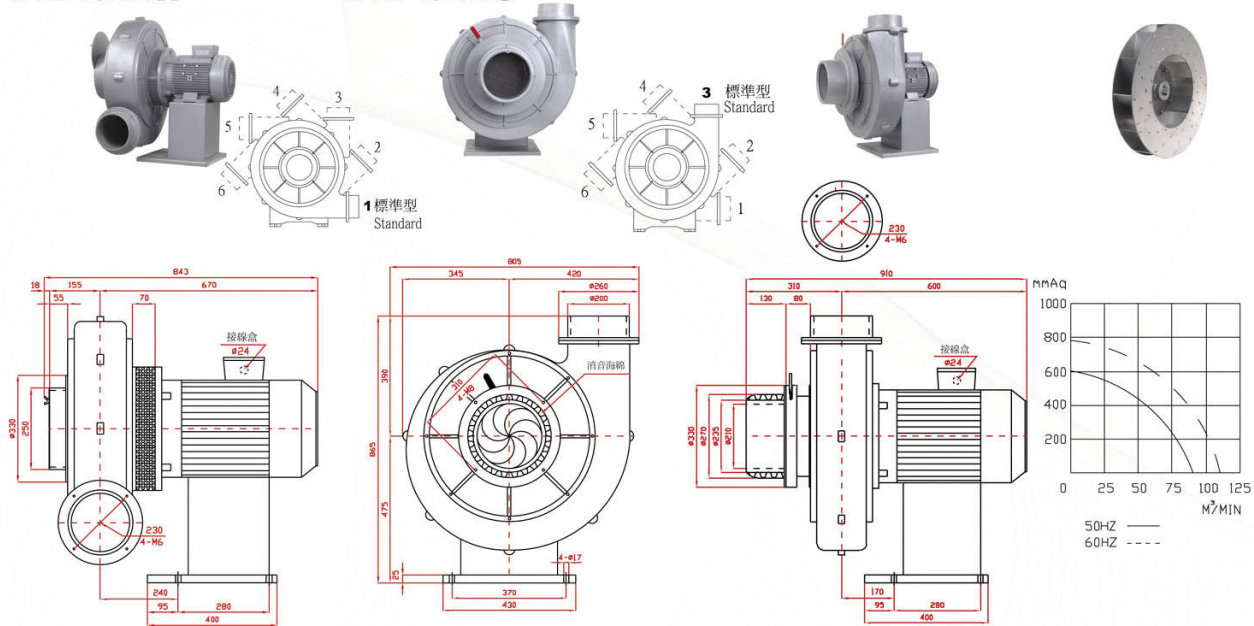

註二：供應電壓如下：三相(3 Phase)—200, 208, 220, 230, 240, 346, 380, 400, 415, 440, 480, 575V
(Note 2)

PS：訂購時請指定電壓與頻率。

When ordering, please specify voltage and frequency.