

# BTH SERIES

**BTH-0200**

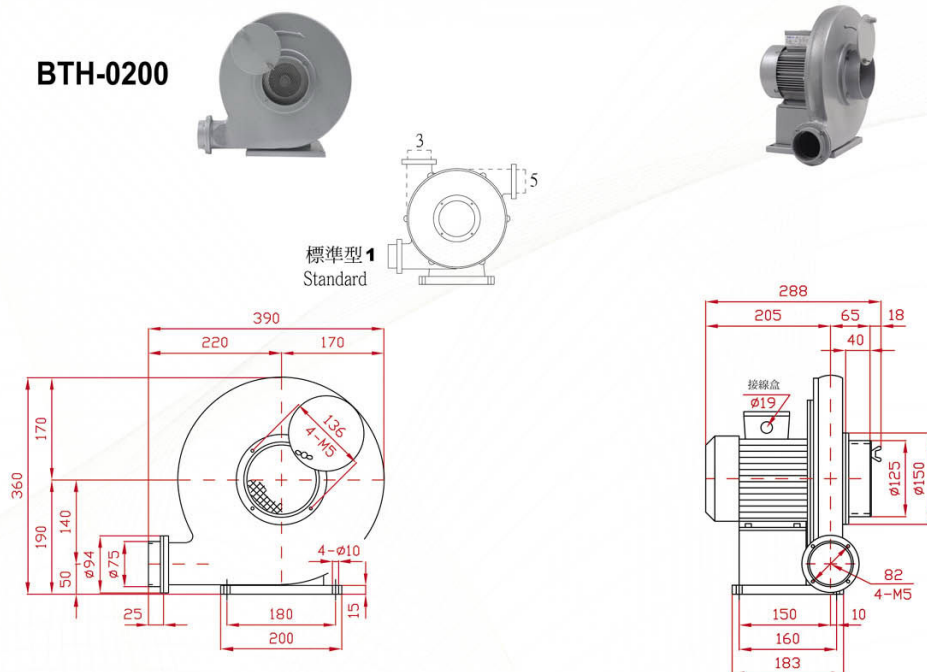

**BTH-0300**

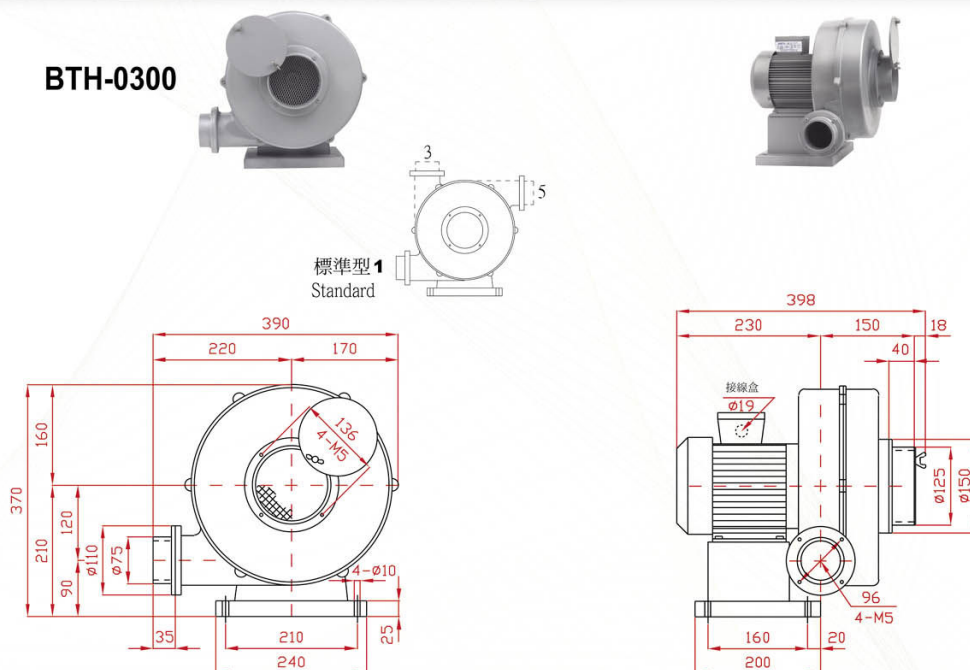

## SPECIFICATIONS

型號 TYPE	功率 KW	出口口徑 MM	電壓 V	頻率 HZ	回轉數 R.P.M.	靜壓 mmAq	最大風量 M <sup>3</sup> /MIN	噪音值 dB(A)	淨重 KG(N.W.)
BTH-0200	0.2	φ 75	請指定電壓，註一 (Note 1)	50	2800	150	4.5	72	13
BTH-0200L				60	3300	220	5.0	78	
BTH-0200H									14
BTH-0300	0.2	φ 75	請指定電壓，註一 (Note 1)	50	2800	200	6.0	73	14
BTH-0300L				60	3300	270	7.0	78	
BTH-0300H									15

說明 Instruction : L Type : 反向(Opposite direction) 、H Type : 防水隔熱型(Waterproof and heat insulation)

**BTH-0200L**

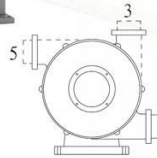

**BTH-0200H**

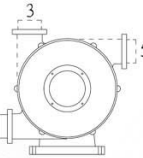

標準型  
Standard

標準型 1  
Standard

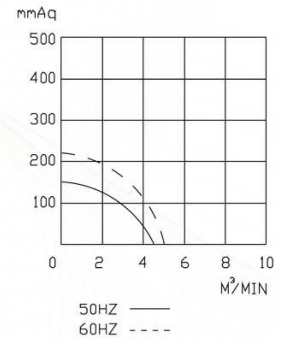
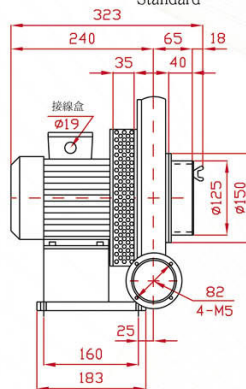
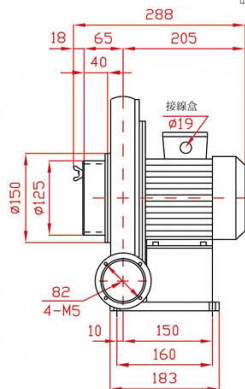

**BTH-0300L**

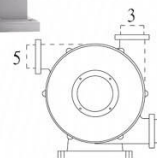

**BTH-0300H**

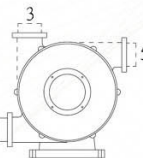

標準型  
Standard

標準型 1  
Standard

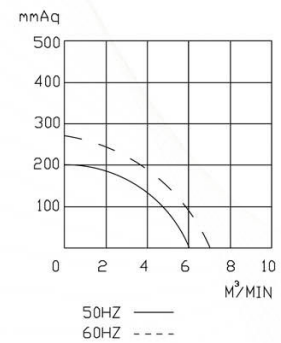
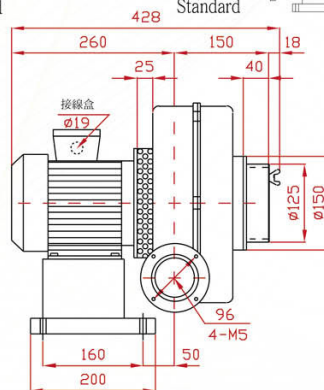
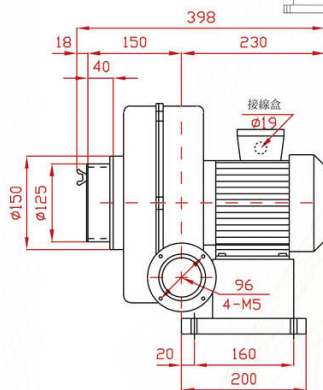

註一：供應電壓如下：單相(1 Phase)—100, 110, 120, 200, 220, 230, 240V

(Note 1)

三相(3 Phase)—200, 208, 220, 230, 240, 346, 380, 400, 415, 440, 480, 575V

PS：訂購時請指定電壓與頻率。

When ordering, please specify voltage and frequency.



# BTH SERIES

**BTH-0400**

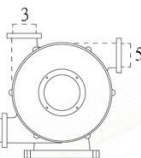

標準型 1  
Standard

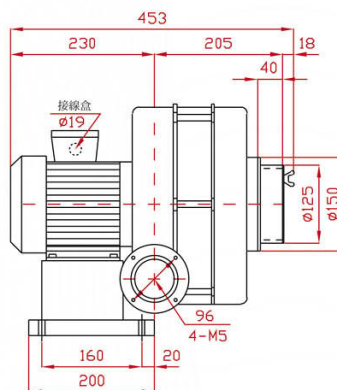
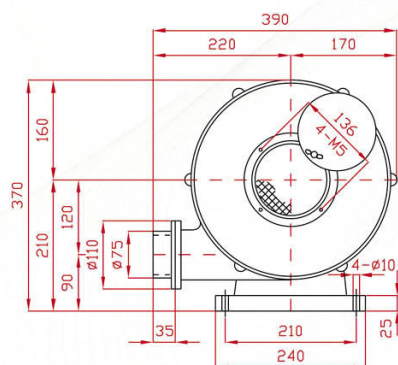

**BTH-0750**

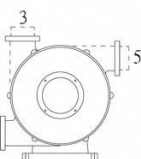

標準型 1  
Standard

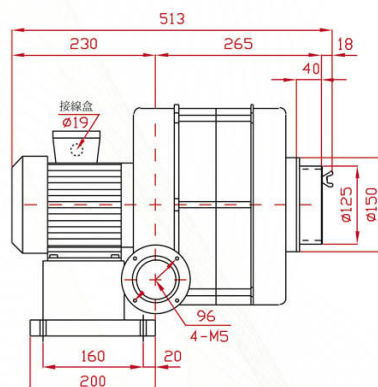
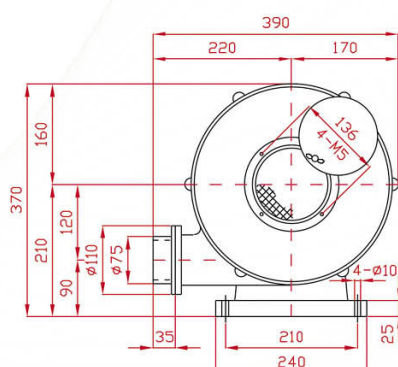

## SPECIFICATIONS

型號 TYPE	功率 KW	出口口徑 MM	電壓 V	頻率 HZ	回轉數 R.P.M.	靜壓 mmAq	最大風量 M <sup>3</sup> /MIN	噪音值 dB(A)	淨重 KG(N.W.)
BTH-0400	0.4	φ 75	請指定電壓，註一 (Note 1)	50	2800	290	7.0	75	19
BTH-0400L				60	3300	400	7.5	80	
BTH-0400H									20
BTH-0750	0.75	φ 75	請指定電壓，註一 (Note 1)	50	2800	460	7.5	78	25
BTH-0750L				60	3300	580	8.0	89	
BTH-0750H									26

說明 Instruction : L Type : 反向(Opposite direction) 、H Type : 防水隔熱型(Waterproof and heat insulation)

**BTH-0400L**



**BTH-0400H**

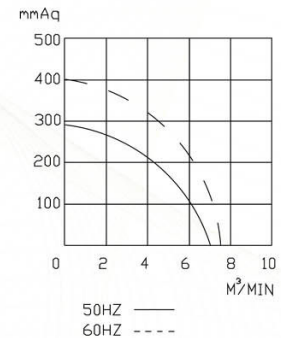
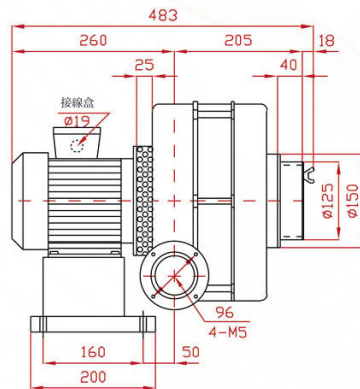
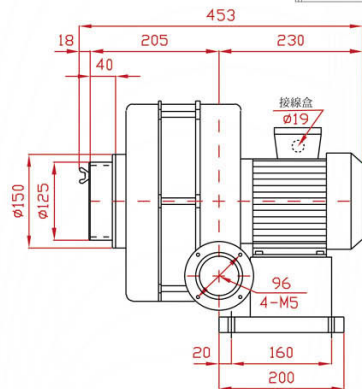
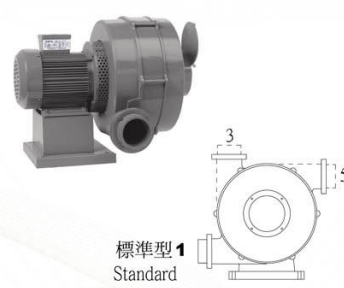

**BTH-0750L**

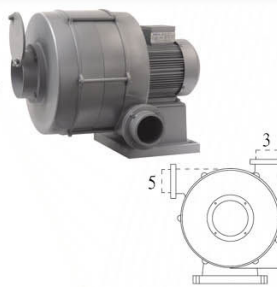

**BTH-0750H**

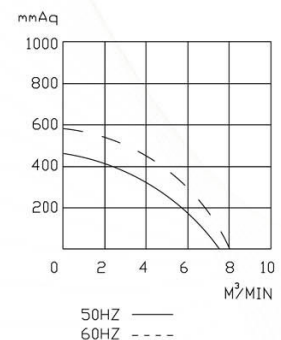
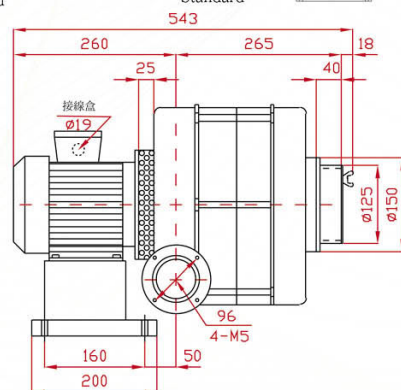
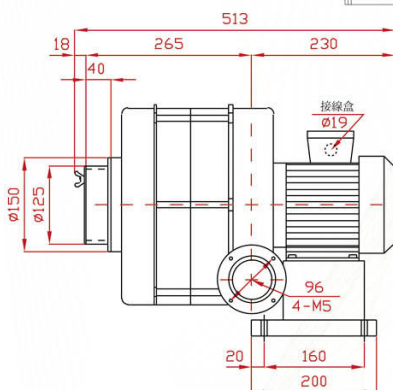

註一：供應電壓如下：單相(1 Phase)—100, 110, 120, 200, 220, 230, 240V

(Note 1)

三相(3 Phase)—200, 208, 220, 230, 240, 346, 380, 400, 415, 440, 480, 575V

PS：訂購時請指定電壓與頻率。

When ordering, please specify voltage and frequency.