

BTS SERIES

BTS-0400

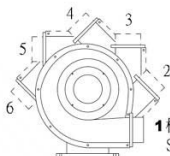

1 標準型
Standard

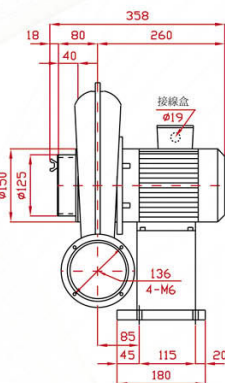
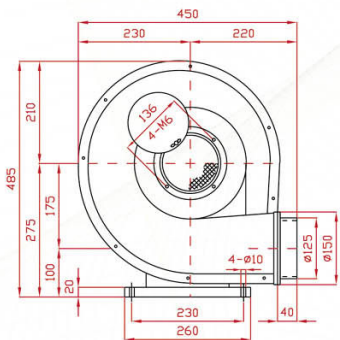

BTS-0400L

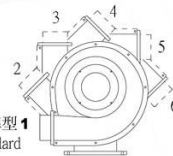

1 標準型
Standard

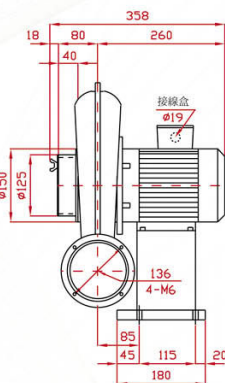
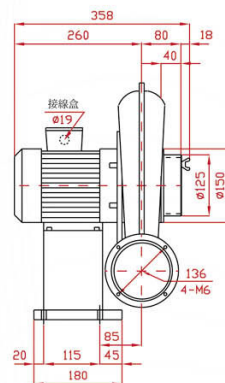

BTS-0750

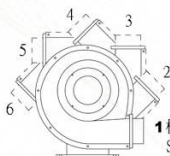

1 標準型
Standard

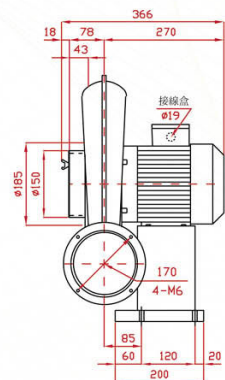
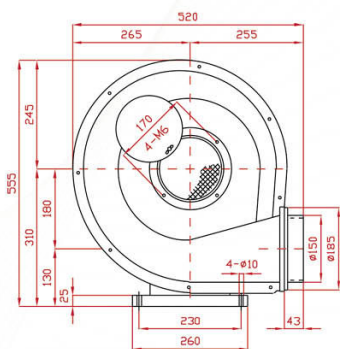

BTS-0750L

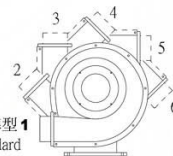

1 標準型
Standard

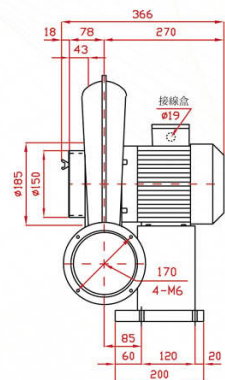
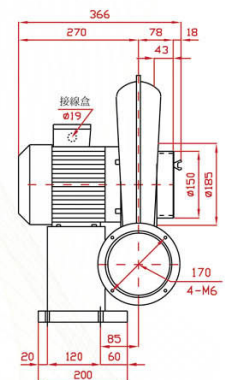

SPECIFICATIONS

型號 TYPE	功率 KW	出口口徑 MM	電壓 V	頻率 HZ	回轉數 R.P.M.	靜壓 mmAq	最大風量 M ³ /MIN	噪音值 dB(A)	淨重 KG(N.W.)
BTS-0400	0.4	φ 125	請指定電壓，註一 (Note 1)	50	2800	135	12	55	19.5
BTS-0400L				60	3300	190	14	76	20.5
BTS-0400C									23
BTS-0750	0.75	φ 150	請指定電壓，註一 (Note 1)	50	2800	190	21	58	28
BTS-0750L				60	3300	210	25	80	29
BTS-0750C									31.5

說明 Instruction: L Type: 反向(Opposite direction)、H Type: 防水隔熱型(Waterproof and heat insulation)、

C Type: 微調入口風門(Micro adjust inlet valve)

BLOTEK 送排風機

<http://www.blotek.com.tw>

BTS-0400H

BTS-0400C

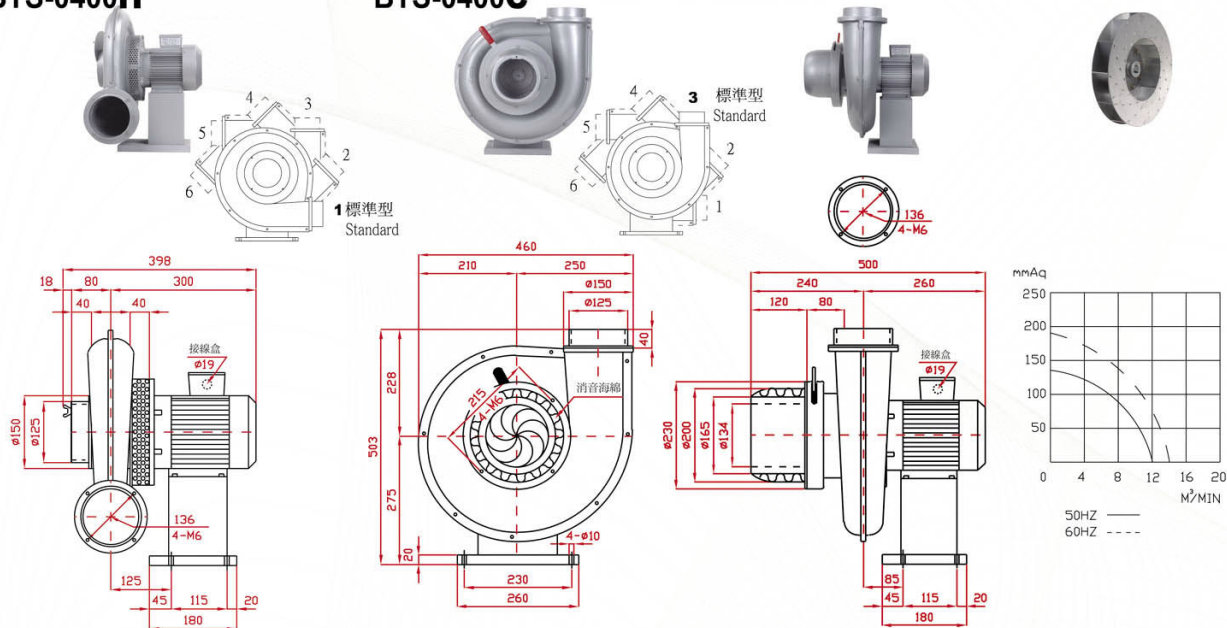

BTS-0750H

BTS-0750C

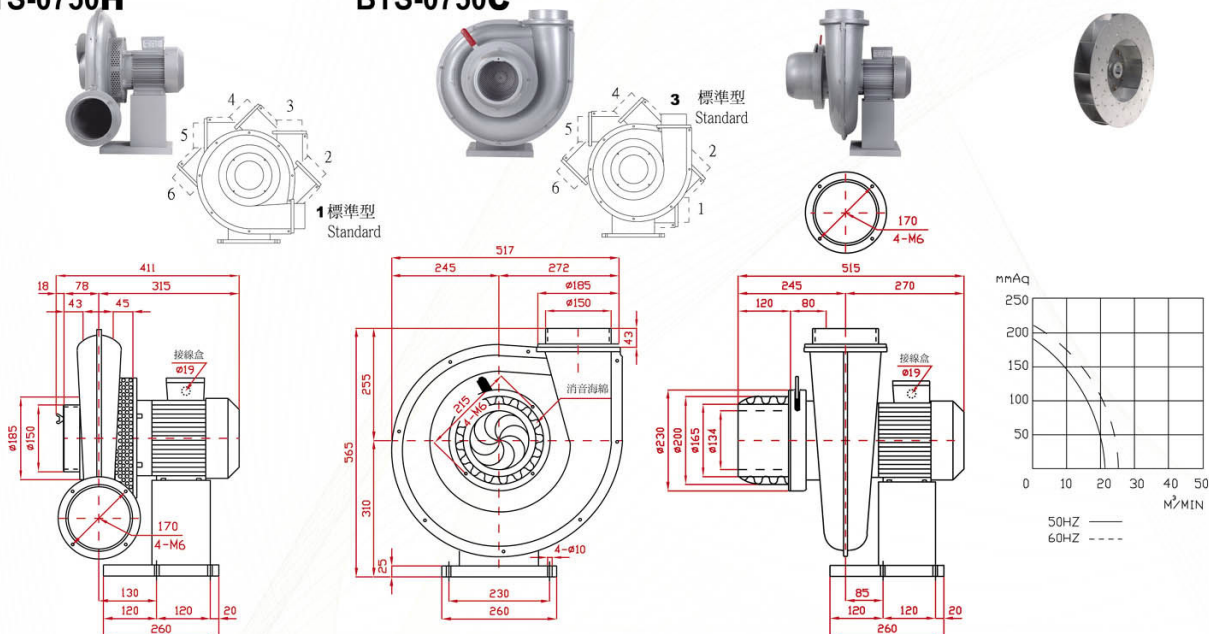

註一：供應電壓如下：單相(1 Phase)—100, 110, 120, 200, 220, 230, 240V
(Note 1) 三相(3 Phase)—200, 208, 220, 230, 240, 346, 380, 400, 415, 440, 480, 575V

PS：訂購時請指定電壓與頻率。
When ordering, please specify voltage and frequency.

BTS SERIES

BTS-1500

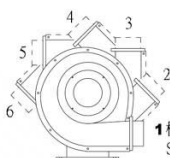

標準型
Standard

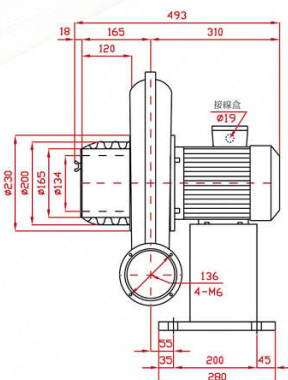
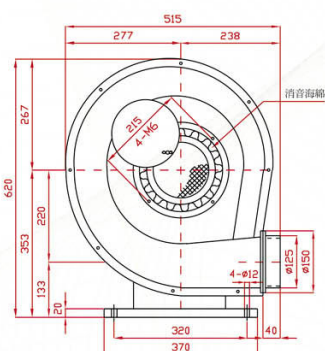

BTS-1500L

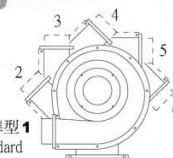

標準型
Standard

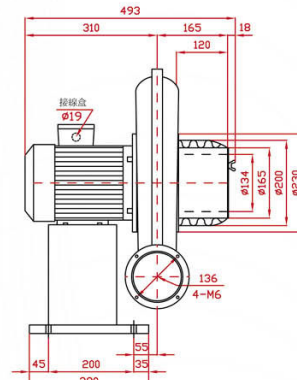

BTS-2200

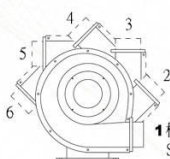

標準型
Standard

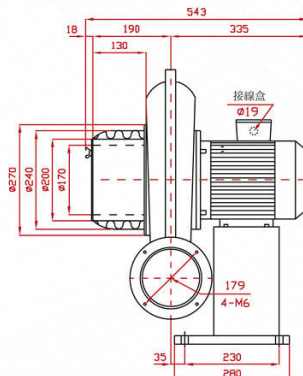
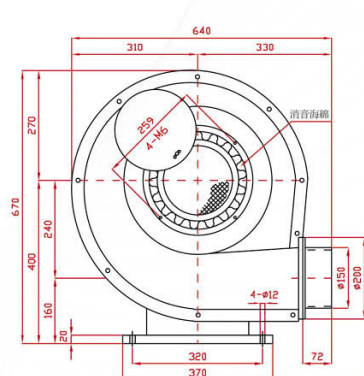

BTS-2200L

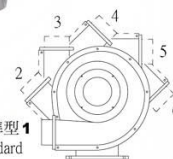

標準型
Standard

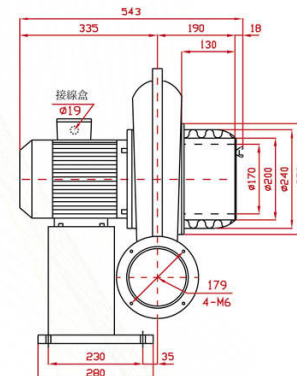

SPECIFICATIONS

型號 TYPE	功率 KW	出口口徑 MM	電壓 V	頻率 HZ	回轉數 R.P.M.	靜壓 mmAq	最大風量 M ³ /MIN	噪音值 dB(A)	淨重 KG(N.W.)
BTS-1500	1.5	φ 125	請指定電壓，註二 (Note 2)	50	2800	200	24	60	46
BTS-1500L				60	3300	250	30	82	47
BTS-1500H									49.5
BTS-1500C									49.5
BTS-2200	2.2	φ 150	請指定電壓，註二 (Note 2)	50	2800	310	28	63	61
BTS-2200L				60	3300	340	34	84	62
BTS-2200H									65.5
BTS-2200C									65.5

說明 Instruction: L Type: 反向(Opposite direction)、H Type: 防水隔熱型(Waterproof and heat insulation)、

C Type: 微調入口風門(Micro adjust inlet valve)

BLOTEK 送排風機 <http://www.blotek.com.tw>

BTS-1500H

BTS-1500C

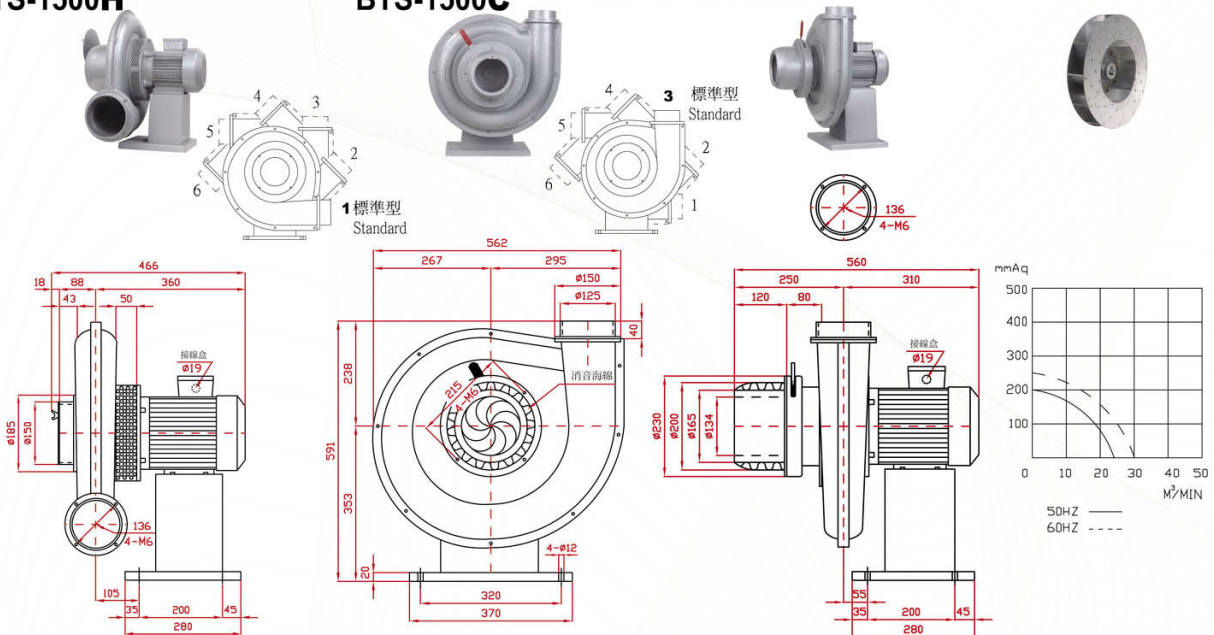

BTS-2200H

BTS-2200C

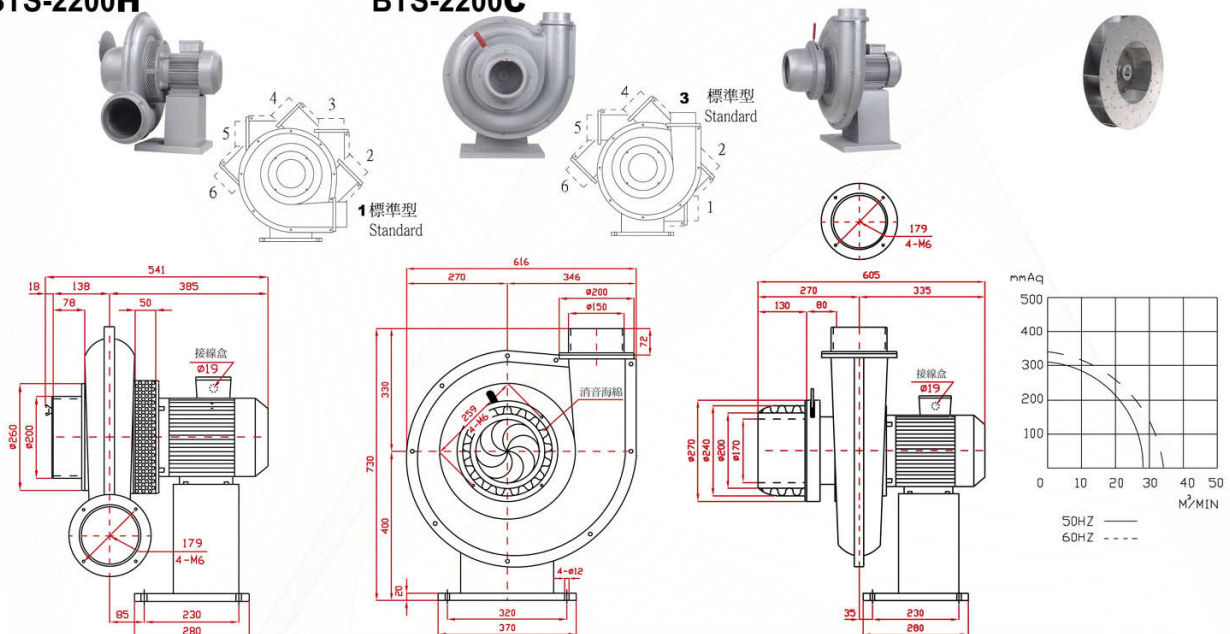

註二：供應電壓如下：三相(3 Phase)—200, 208, 220, 230, 240, 346, 380, 400, 415, 440, 480, 575V
(Note 2)

PS：訂購時請指定電壓與頻率。

When ordering, please specify voltage and frequency.

BTS SERIES

BTS-3700

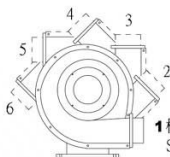

標準型
Standard

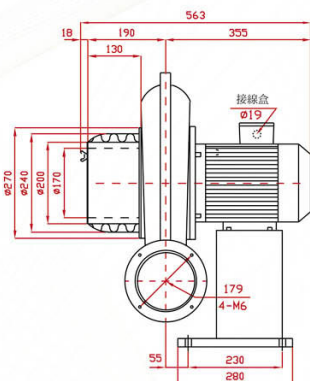
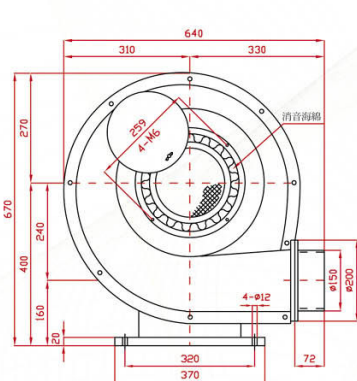

BTS-3700L

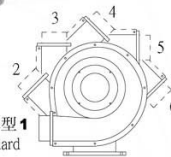

標準型
Standard

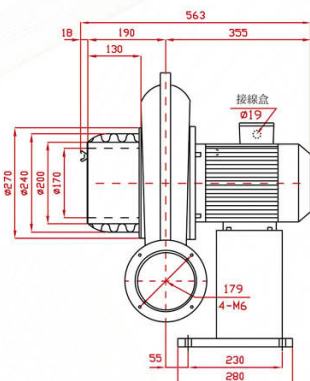
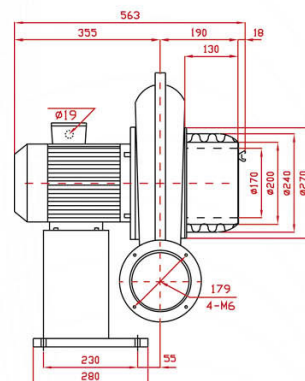

BTS-5500

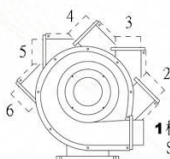

標準型
Standard

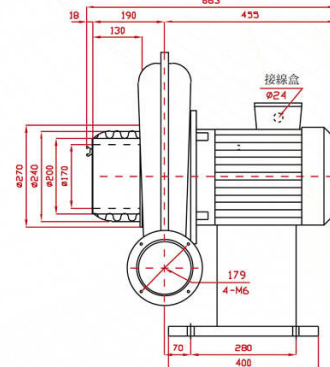
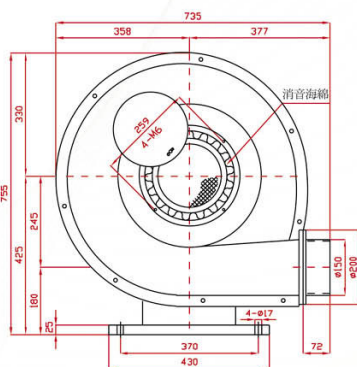

BTS-5500L

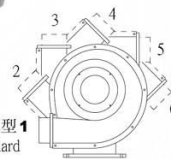

標準型
Standard

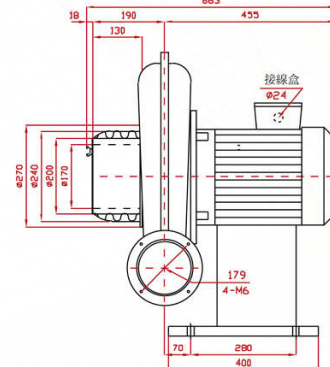
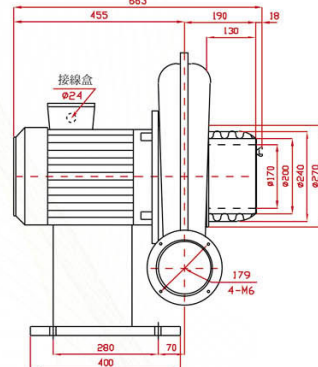

SPECIFICATIONS

型號 TYPE	功率 KW	出口口徑 MM	電壓 V	頻率 HZ	回轉數 R.P.M.	靜壓 mmAq	最大風量 M ³ /MIN	噪音值 dB(A)	淨重 KG(N.W.)
BTS-3700	3.7	φ 150	請指定電壓，註二 (Note 2)	50	2800	380	35	65	71
BTS-3700L				60	3300	480	50	87	72.5
BTS-3700H									75.5
BTS-5500	5.5	φ 150	請指定電壓，註二 (Note 2)	50	2800	450	48	70	115
BTS-5500L				60	3300	530	60	90	116.5
BTS-5500H									119.5

說明 Instruction: L Type: 反向(Opposite direction)、H Type: 防水隔熱型(Waterproof and heat insulation)、

C Type: 微調入口風門(Micro adjust inlet valve)

BLOTEK 送排風機

<http://www.blotek.com.tw>

BTS-3700H

BTS-3700C

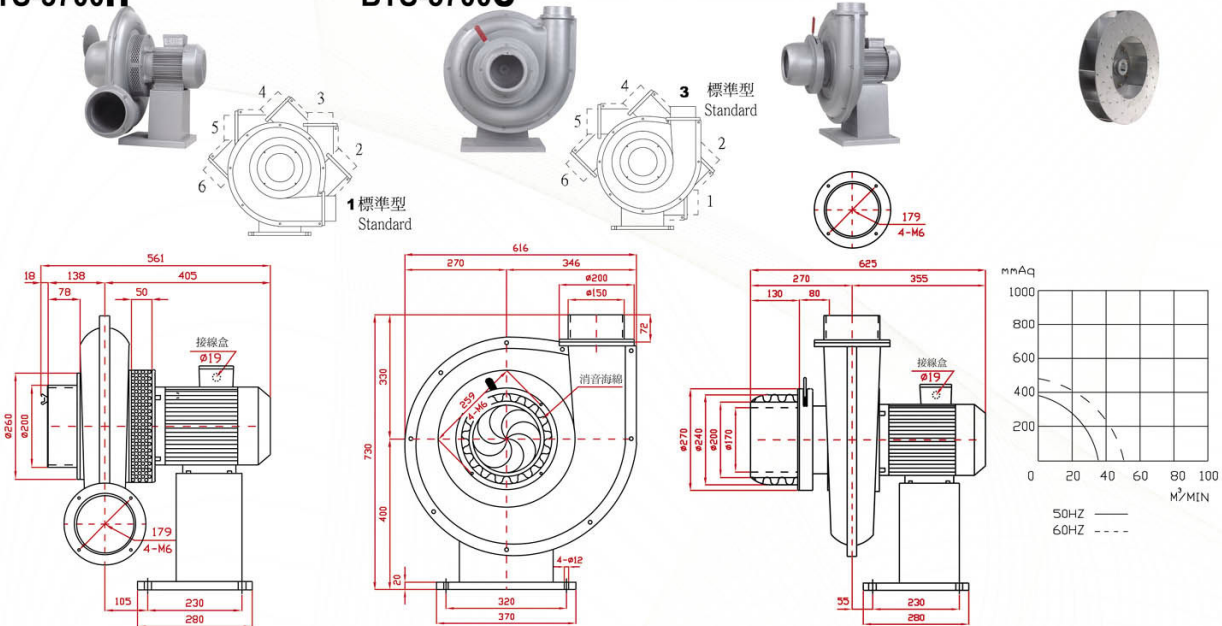

BTS-5500H

BTS-5500C

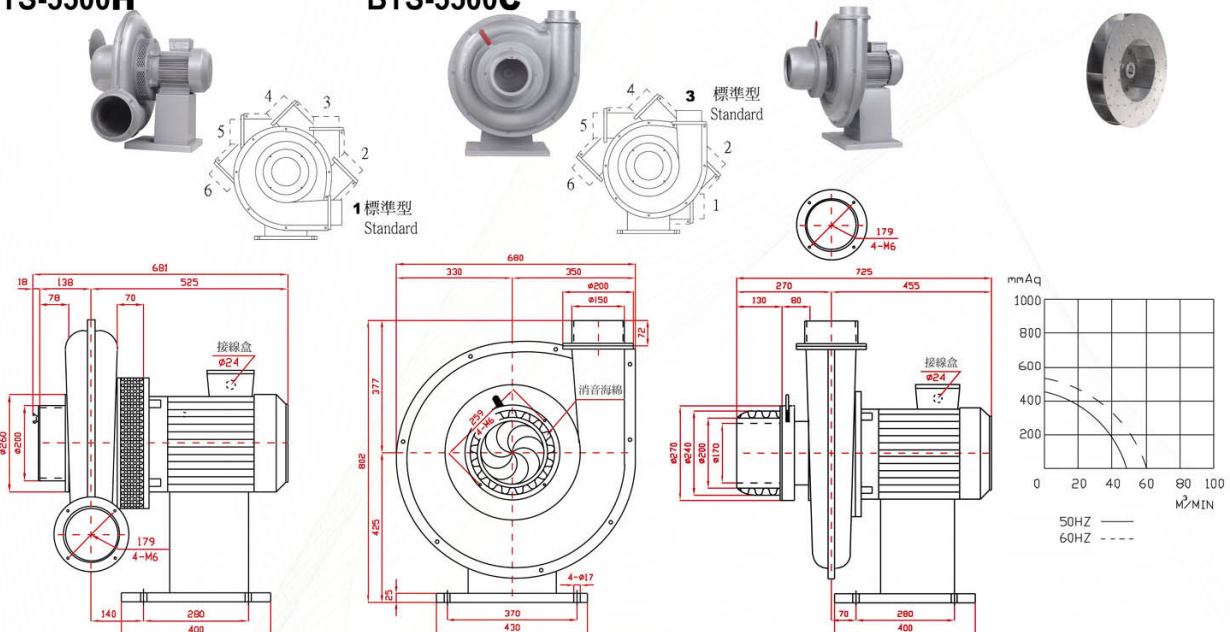

註二：供應電壓如下：三相(3 Phase)—200, 208, 220, 230, 240, 346, 380, 400, 415, 440, 480, 575V (Note 2)

PS：訂購時請指定電壓與頻率。

When ordering, please specify voltage and frequency.

BTS SERIES

BTS-7500

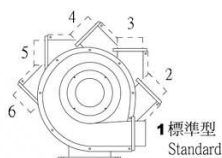

標準型
Standard

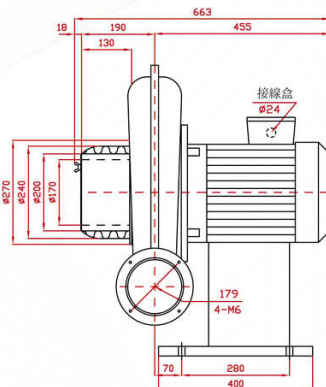
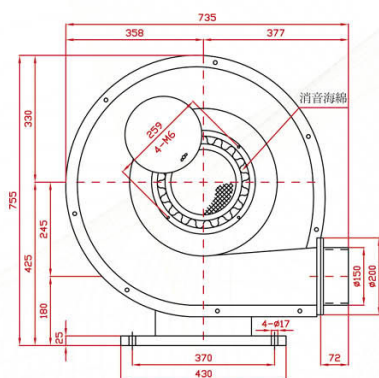

BTS-7500L

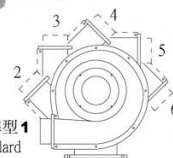

標準型
Standard

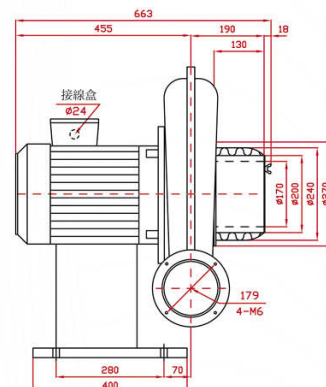

BTS-11KW

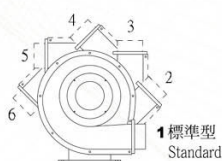

標準型
Standard

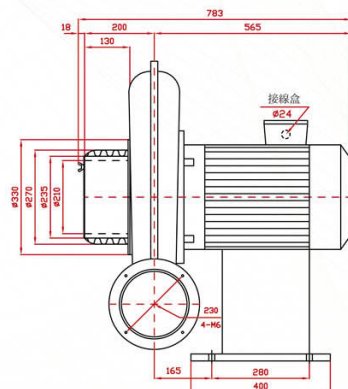
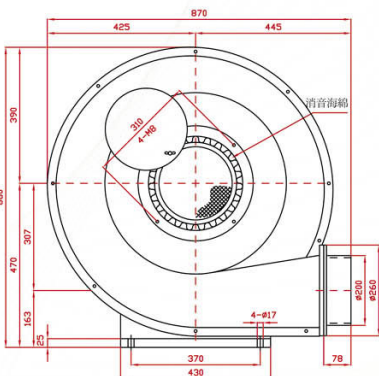

BTS-11KWL

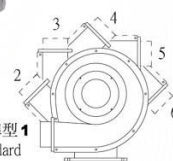

標準型
Standard

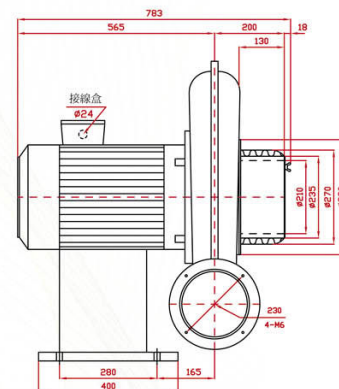

SPECIFICATIONS

型號 TYPE	功率 KW	出口口徑 MM	電壓 V	頻率 HZ	回轉數 R.P.M.	靜壓 mmAq	最大風量 M ³ /MIN	噪音值 dB(A)	淨重 KG(N.W.)
BTS-7500	7.5	φ 150	請指定電壓，註二 (Note 2)	50	2800	500	54	80	126
BTS-7500L				60	3300	620	70	95	127.5
BTS-7500H									130.5
BTS-11KW	11.2	φ 200	請指定電壓，註二 (Note 2)	50	2800	540	80	89	177
BTS-11KWL				60	3300	720	95	105	178.5
BTS-11KWH									183.5

說明 Instruction : L Type : 反向(Opposite direction) 、H Type : 防水隔熱型(Waterproof and heat insulation) 、

C Type : 微調入口風門(Micro adjust inlet valve)

BLOTEK 送排風機

<http://www.blotek.com.tw>

BTS-7500C

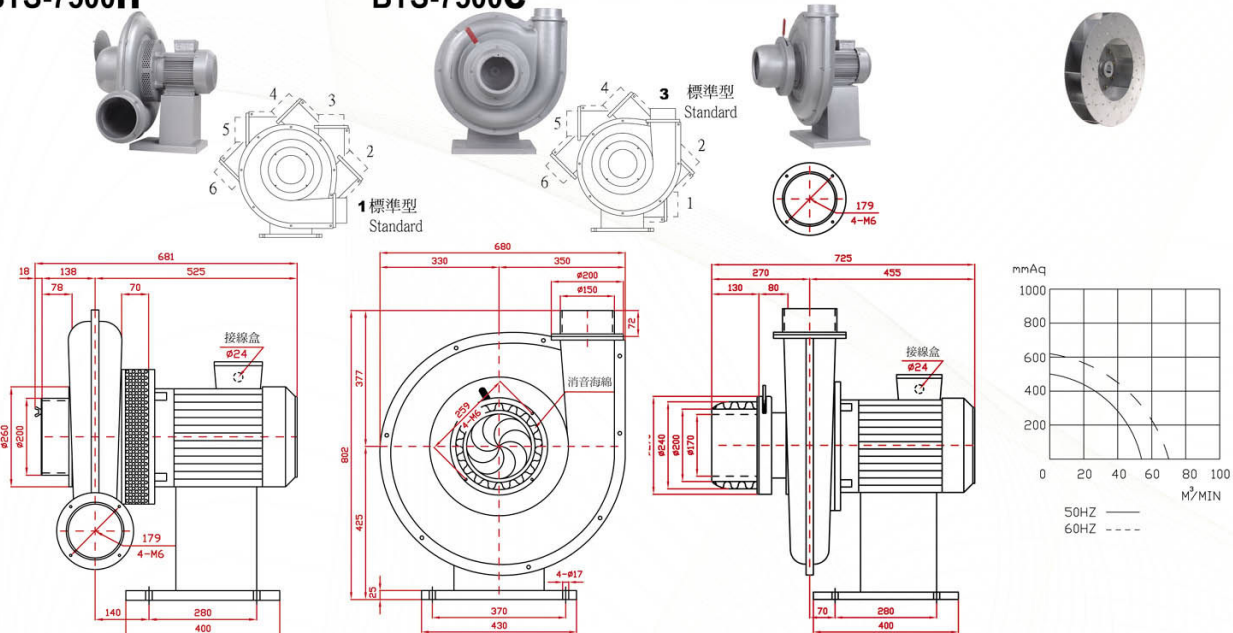

BTS-11KWC

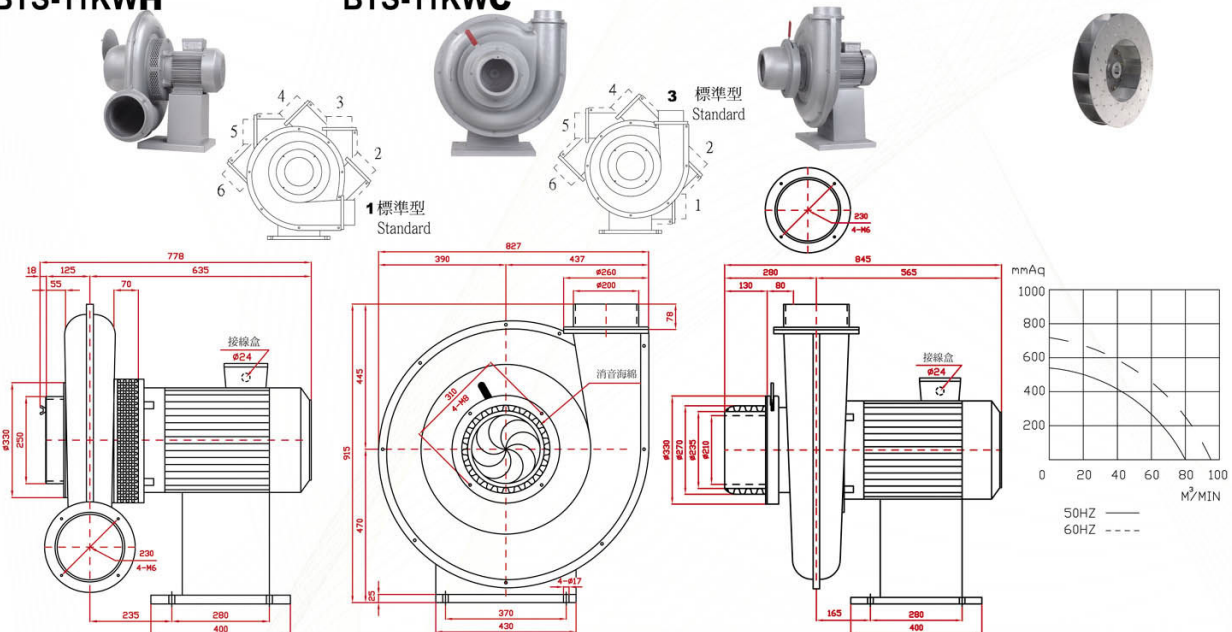

註二：供應電壓如下：三相(3 Phase)—200, 208, 220, 230, 240, 346, 380, 400, 415, 440, 480, 575V
(Note 2)

PS：訂購時請指定電壓與頻率。

When ordering, please specify voltage and frequency.

BTS SERIES

BTS-15KW

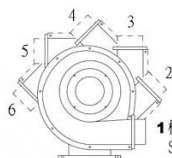

1 標準型
Standard

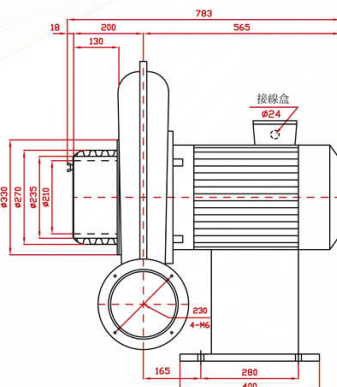
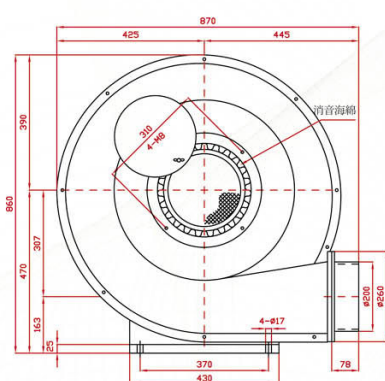

BTS-15KWL

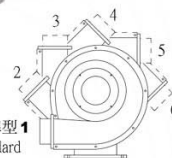

標準型 1
Standard

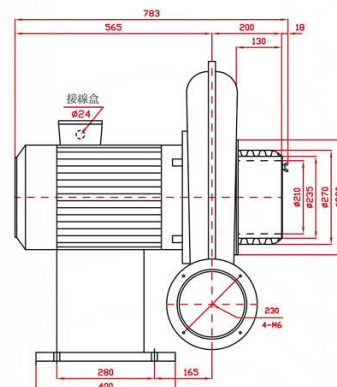

SPECIFICATIONS

型號 TYPE	功率 KW	出口口徑 MM	電壓 V	頻率 HZ	回轉數 R.P.M.	靜壓 mmAq	最大風量 M³/MIN	噪音值 dB(A)	淨重 KG(N.W.)
BTS-15KW	15	φ 200	請指定電壓，註二 (Note 2)	50	2800	600	90	93	195
BTS-15KWL				60	3300	780	108	113	196.5
BTS-15KWH									201.5
BTS-15KWC									

說明 Instruction : **L** Type : 反向(Opposite direction)、**H** Type : 防水隔熱型(Waterproof and heat insulation)、**C** Type : 微調入口風門(Micro adjust inlet valve)

BTS-15KWC



PS：訂購時請指定電壓與頻率。

When ordering, please specify voltage and frequency.